

PART NUMBER SYSTEM FOR TFL, THO & THF HANGERS

Part Numbers assigned to *TFL*, *THO*, and *THF* I-Joist hangers reveal the I-Joist sizes to be used with the specific hanger. This guide will teach you how to recognize I-Joist dimensions in the part numbers.

TFL/THO
Top Mount
I-Joist Hanger

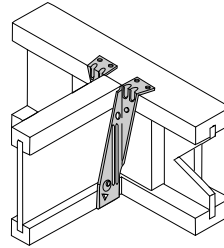

THF
Face Mount
I-Joist Hanger

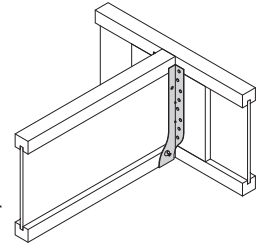

THO25925-2

THO

Letters refer to Hanger Series
ex.: THO

25

First (2) Digits refer to Member Width
ex.: 2.5 inches

925

Last (2) or (3) Digits refer to Member Height
ex.: 9.25 inches

-2

Digits after Dash refer to Number of Plys
ex.: 2 ply

TFL 23118

1st, 3rd, and sometimes 4th digits are whole numbers
(This example denotes 2 and 11)
4th digit may be part of a decimal – ex.: THO15925

2nd and 5th digits are decimals (see guide below)
(This example denotes .3125 [5/16] and .875 [7/8])
5th digit may be (0) or dropped if height is even

Some Examples:

THO15950	1-1/2" x 9-1/2"
THF17925	1-3/4" x 9-1/4"
THO20950-2.....	double 2" x 9-1/2"
THF23140-2.....	double 2-5/16" x 14"

Note: USP's *Full Line Catalog* lists a range of heights for *THF* hangers. Face mount hangers can usually accommodate more than one I-Joist height. The hanger height must be tall enough to support the top chord of the I-Joist to eliminate web stiffener requirements on solid sawn or joists with web stiffeners. The *THF* hanger must be a minimum of 60% of the joist height.

Part Number Guide for Decimals

1 = .125	or	1/8 inch
2 or 25 = .25	or	1/4 inch
3 = .3125	or	5/16 inch
5 = .5	or	1/2 inch
6 = .625	or	5/8 inch
7 = .75	or	3/4 inch
8 = .875	or	7/8 inch



USP supplies quality products to build Stronger Safer Structures

Customer Service:
Burnsville, MN
Phone: 1-800-328-5934
Fax: 1-507-364-8762

Manufacturing:
Montgomery, MN • Livermore, CA
Largo, FL • Thornhill, Ontario

Warehouses:
Houston, TX
Lumberton, NJ

www.USPconnectors.com

A GIBRALTAR INDUSTRIES COMPANY

Information valid until December 10, 2010.

USP634-091