

DTB-TZ

DECK TIE BRACKET

Material: 14 gauge
Finish: G-185

Installation:

- Use all specified fasteners.
- Position DTB-TZ on deck joist in a location where the threaded rod or bolt may be threaded through the bolt hole.
- Drive WS15-GC wood screws into joist.
- Re-install threaded rod or anchor bolt. Secure with washer and nut.
- Tighten anchor bolt nuts finger tight snug to base plus 1/8 to 1/2 additional turns with wrench. To prevent loosening of the anchor nut during critical loading, use a locking nut or tighten a second nut over the first to lock nuts in place.

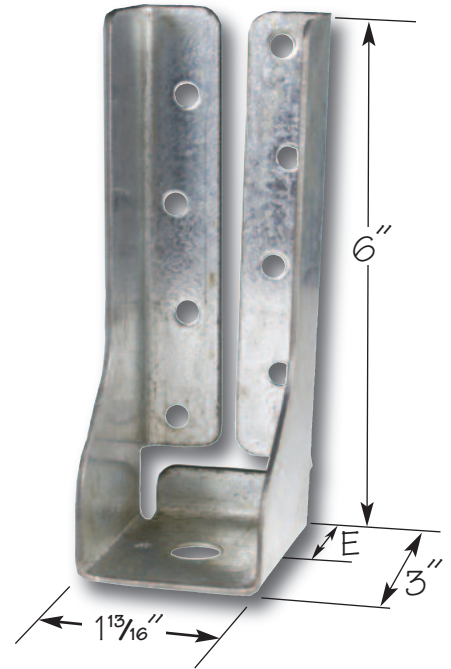

DTB-TZ

Code Watch

The building codes specify that the deck to the house attachment must be designed to resist lateral loads. The lateral load connection shall be permitted to be in accordance with Figure R502.2.2 of the International Residential Building Code. Holdown tension devices shall be provided in not less than two locations per deck, and each device shall have an allowable stress design capacity of not less than 1500 lbs.

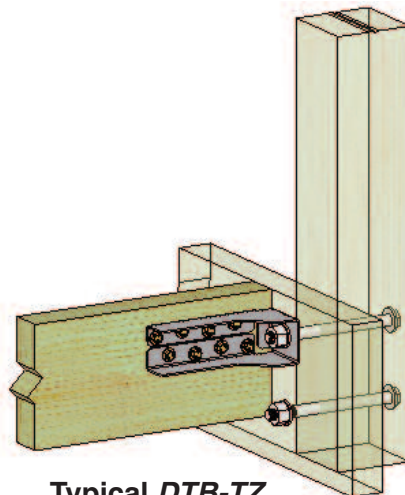

Typical DTB-TZ installation

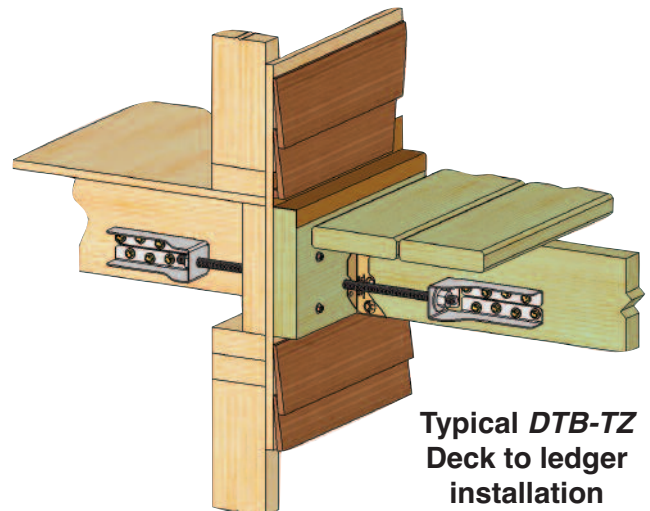

Typical DTB-TZ Deck to ledger installation

New Product

Multiple uses:

- » Reinforces the connection of rail posts to a deck.
- » Provides lateral strength of deck-to-ledge attachment by securing deck to house framing.

Features:

- » Offers lateral resistance.
- » Meets new building code requirements.
- » WS15-GC Wood Screws are supplied with DTB-TZ.

USP supplies quality products to build Stronger Safer Structures

Customer Service:
Burnsville, MN
Phone: 1-800-328-5934
Fax: 1-507-364-8762

Manufacturing:
Montgomery, MN
Livermore, CA
Largo, FL
Thornhill, Ontario

Warehouses:
Houston, TX
Lumberton, NJ

USP Stock No.	Ref. No.	Rod / Bolt Anchor Dia.	E	Fastener Schedule ¹		Allowable Tension (Lbs)				Ctn Qty
				Qty	Wood Screws	DF-L / SP		S-P-F		
						100%	160%	100%	160%	
DTB-TZ	DTT2Z	1/2	1-1/4	8	WS15-GC	1840	1890	1505	1590	25

¹) WS15 Wood Screws are 1/4" dia. x 1-1/2" long and are included with DTB-TZ Deck Tie-Brackets. Consult USP for pricing.