

UPLIFT CONNECTIONS FOR WOODTONE REAL POST

USP Structural Connectors® recently conducted testing to determine uplift capacities to a Woodtone Real Post hollow column. The allowable uplift capacities listed in the chart below are based on testing and calculation for the reduced material thickness of the Woodtone Real Post hollow column and are the lesser of the following:

- Lowest 1/8" Δ from testing
- Lowest Ultimate test value / 3 (Factor of Safety = 3)
- Fastener calculations

Installation:

- Use all specified fasteners.
- WS3 Wood Screws, 1/4" dia. x 3" long, are supplied with KCCQ Column Caps.
- WS2-HDG Wood Screws, 1/4" dia. x 2" long, are supplied with CBSQ Column Bases.
- CBSQ Bases require a minimum edge distance of 3".
- PA725 is not recommended for fence posts or other unrestrained (not fixed or fastened at top) applications. These anchors are not designed to resist overturning (moment loads).

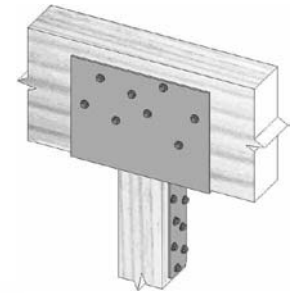

Typical **KCCQ** installation

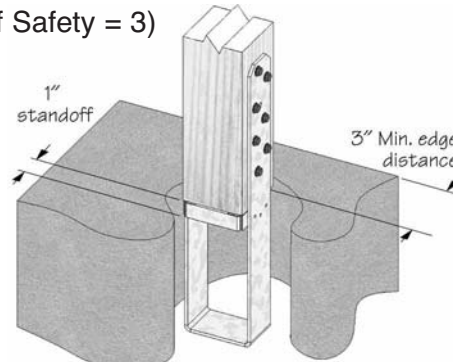

Typical **CBSQ44-TZ** installation

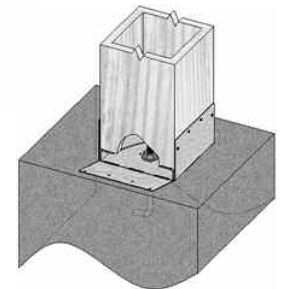

Typical **PA725** installation

| Column Size | USP Stock No. | Ref. No. | Fastener Schedule ⁶ | | | DF-L / SP Allowable Loads | | |
|---------------------|---------------|-------------|--------------------------------|----------|----------------|---------------------------|---------------------------|------|
| | | | Anchor Bolt | Beam | Column or Post | 100% | Uplift ^{1,2,4,5} | |
| | | | | | | | 133% | 160% |
| Column Caps | | | | | | | | |
| 4 x 4 | KCCQ44 | CCQ44SDS2.5 | -- | (16) WS3 | (14) WS3 | -- | 3835 | 4600 |
| 4 x 6 | KCCQ46 | CCQ46SDS2.5 | -- | (16) WS3 | (14) WS3 | -- | 3835 | 4600 |
| 6 x 6 | KCCQ48 | CCQ48SDS2.5 | -- | (16) WS3 | (14) WS3 | -- | 3835 | 4110 |
| Column Bases | | | | | | | | |
| 4 x 4 | CBSQ44-TZ | CBSQ44-SDS2 | -- | -- | (14) WS2-HDG | -- | 3665 | 4400 |
| 4 x 6 | CBSQ46-TZ | CBSQ46-SDS2 | -- | -- | (14) WS2-HDG | -- | 3665 | 4400 |
| 6 x 6 | CBSQ66-TZ | CBSQ66-SDS2 | -- | -- | (14) WS2-HDG | -- | 3665 | 4400 |
| Post Anchors | | | | | | | | |
| 7-1/4 x 7-1/4 | PA725 | -- | 1/2 | -- | (16) 16d | 6950 | 555 | 555 |

- 1) KCCQ and CBSQ models: Uplift loads are based on the 1997 NDS®.
- 2) Uplift Loads have been increased 33-1/3% or 60% for wind and seismic loads, no further increase shall be permitted.
- 3) Spliced conditions must be detailed by the specifier to transfer tension loads between spliced members by means other than the column cap.
- 4) Uplift loads do not apply to splice conditions.
- 5) Allowable Loads are based on lumber with a specific gravity of 0.42, and a moisture content of 19% or less.
- 6) Minimum nail embedment shall be 1-5/8" for 16d nails.

TECH BULLETIN

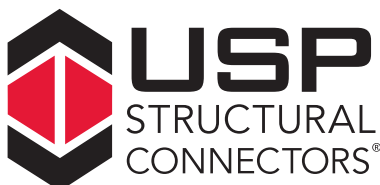

USP supplies quality products to build Stronger Safer Structures

Customer Service:
Burnsville, MN
Phone: 1-800-328-5934
Fax: 1-952-898-8683

Manufacturing:
Montgomery, MN • Livermore, CA
Largo, FL • North Wilkesboro, NC
Rancho Cucamonga, CA • Thornhill, Ontario

Warehouses:
Houston, TX
Lumberton, NJ

www.USPconnectors.com

A GIBRALTAR INDUSTRIES COMPANY

Information valid until December 31, 2007.

USP1020-071