

Deck Tie Brackets reinforce the connection of rail posts to a deck. Also provides lateral strength of deck-to-ledger attachment by securing deck to house framing.

**Materials:** 14 gauge  
**Finish:** G-185 galvanizing

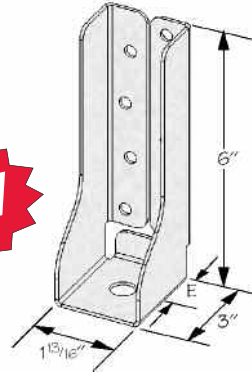

**DTB-TZ**

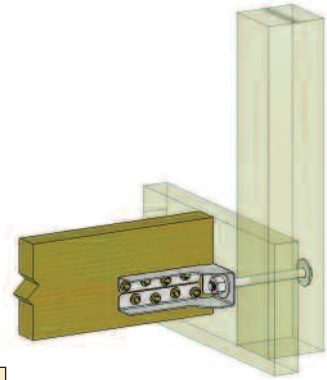

**Typical DTB-TZ installation**

**Installation:**

- Use all specified fasteners.
- Position DTB-TZ on deck joist in a location where the threaded rod or bolt may be threaded through the bolt hole.
- Drive WS15-GC wood screws into joist.
- Re-install threaded rod or anchor bolt. Secure with washer and nut.
- Tighten anchor bolt nuts finger tight snug to base plus 1/3 to 1/2 additional turns with wrench. To prevent loosening of the anchor nut during critical loading, use a locking nut or tighten a second nut over the first to lock nuts in place.

The building codes specify that the deck to the house attachment must be designed to resist lateral loads. The lateral load connection shall be permitted to be in accordance with Figure R502.2.2 of the International Residential Building Code. Holdown tension devices shall be provided in not less than two locations per deck, and each device shall have an allowable stress design capacity of not less than 1500 lbs.

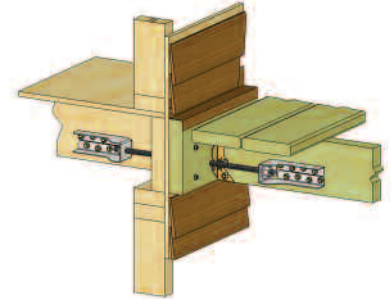

**Typical DTB-TZ Deck to ledger installation**

USP Stock No.	Ref. No.	Rod / Bolt Anchor Dia.	E	Fastener Schedule <sup>1</sup>		Allowable Tension (Lbs)				Code Ref.
				Qty	Wood Screws	DF-L / SP		S-P-F		
						100%	160%	100%	160%	
<b>DTB-TZ</b>	DTT2Z	1/2	1-1/4	8	WS15-GC	1840	1890	1505	1590	130

<sup>1</sup> WS15-GC Wood Screws are 1/4" dia. x 1-1/2" long and are included with DTB-TZ Deck Tie-Backs. New products or updated product information are designated in red.

## DECK POST TIES – SDJT 14 & SDPT SERIES

**SDPT** – Connects 2 x 4 stair posts and 4 x 4 posts to deck rim joist or stair stringers.

**SDJT14** – Secures 2x joists to posts.

**Materials:** 14 gauge  
**Finish:** G-185 galvanizing

**Installation:**

- Use all specified fasteners. See Product Notes, page 10.
- **SDPT5-TZ** & **SDPT7-TZ** – Install units in pairs on 2x4 (SDPT5-TZ) or 4x4 (SDPT7-TZ) post. Space the connectors 5" apart from center to center on the post. Use through bolts to fasten connectors to rim joist or stringer. Do not use lag bolts. Fasten to post with specified nails (see chart).
- **SDJT14-TZ** – Use with 2x lumber for joists (minimum height is 2x4). Install with either specified nails or through bolts. Do not use lag bolts. To ease installation, attach to 4x4 post first.

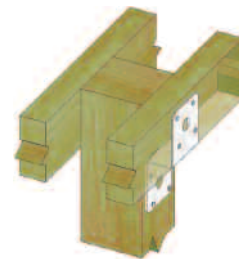

**Typical SDJT14-TZ installation**

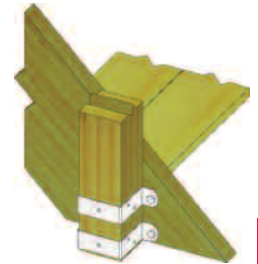

**Typical SDPT7-TZ installation**

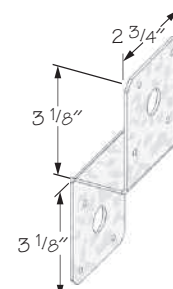

**SDJT14-TZ**

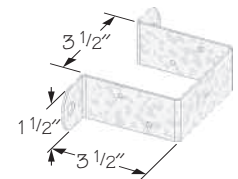

**SDPT7-TZ**

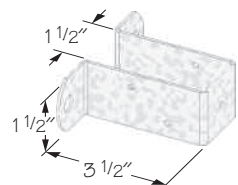

**SDPT5-TZ**

Post Size	USP Stock No.	Ref. No.	Steel Gauge	Fastener Schedule				Allowable Loads (Lbs.)						Code Ref.		
				Nails <sup>1,2</sup>		Bolts <sup>3</sup>		DF-L / SP								
				Qty	Type	Qty	Dia.	Nails			Bolts					
2 x 4	SDPT5-TZ	DPT5Z	14	5	10d x 1-1/2	2	3/8	---	---	---	---	---	---	---	---	120
4 x 4	SDPT7-TZ	DPT7Z	14	5	10d x 1-1/2	2	3/8	---	---	---	---	---	---	---	---	130
4 x 4	SDJT14-TZ	DJT14Z	14	8	16d	2	3/8	1120	1290	1400	1400	1400	1400	1400	1400	130

<sup>1</sup> 10d x 1-1/2 nails are 9 gauge (0.148" diameter) by 1-1/2" long.  
<sup>2</sup> Nails require a minimum embedment length of 1-5/8" for 16d nails.  
<sup>3</sup> Bolts shall conform to ASTM A 307 or better.

Miscellaneous