

A3 Angle Clip71-72, 210
AB Anchor Bolts35, 210
ABC Anchor Bolt Caps33
ABH Anchor Bolt Holders32
ABHS Anchor Bolt Holders
 & Spacers32
ABS12 Anchor Bolt Stabber33
ABSL Anchor Bolt Sleeves33
AC Angle Clips71-72, 210
ACR Adhesive (**CIA-EA**)30
Alternate Installations192
ANJ44S Heavy Angles76, 210
ANSI/TPI Allowable Loads193
B Bolts26
B Corner Reinforcements76
BL Corner Reinforcements76
BN Breakfast Nook Hangers181
BP Bearing Plates26, 210
BPH Beam & Purlin Hangers
 126, 130-131, 135-139, 142-146
BRN Bridging195
C Post Caps62, 210
CBE Column Bases60
CBS Column Bases59, 210
CBSQ Column Bases58, 210
CH Gazebo Hub Plates202
CLPBF Butterfly Hanger174
CMST Coiled Strapping78
CMSTC16 Coiled Strapping78
Corrosion Resistant Products ..210
CPB Composite Post Bases63
CSH Concealed Stringer Hanger ..201,
 210
D Post Anchors58, 210
DBC44 Post Anchor58
DBF44 Post Anchor58
DC1 Drywall Clip203
DC50 Deck Clip200, 210
DSC4 Drag Strut Connector191
DTC Truss Anchor160-161
DUC Ductile Undercut Anchors ...29
EBG44 Elevated Post Base ..57, 210
EPB Elevated Post Bases57, 210
EPCM End Post Caps61, 210
ERB24 Fence Bracket199, 210
EWP Hanger Selector Guide116
EWP Installation119-120
FA3 Foundation Anchors ..36-37, 210
FB Fence Brackets199, 210
FBS Form Board Spacer33
FH Formed Seat Hangers109
FHD Formed Seat Hangers109
FRB Fence Brackets199, 210
FS Truss Field Splice Kits189
FSS Truss Field Splice Kits189
FT Concrete Form Ties35
FTC Floor Truss Clips186
G Bridging195-196
GEL Adhesive (**CIA-GEL 7000**) ...31
GHF Glulam Face Mount Hangers .149,
 206-207, 210

GT Girder Truss Hangers183-184
GTD Girder Truss Hangers ...183-184
GTS Girder Truss Hangers ...183-184
GTU Girder Truss Hangers185
GTWS Girder Truss Hangers185
Hanger Selector Guide88
HBPS Bearing Plates26, 210
HC520 Hurricane/Seismic Anchor 167, 169
HCPRS Hurricane/Seismic Anchors
 167, 169
HD Face Mount Hangers93-100,
 121, 123-125, 206-207
HDO Top Mount Hangers .101, 103-105
 206, 208-209
HGA Hurricane Gusset Angles ...167
HH Header Hangers75
HHC Hip/Hip Connectors182
HHCP2 Hurricane/Seismic Anchor
 167-169, 210
HHDO Top Mount Hangers101,
 103-105, 206, 208-209
HJC Hip/Jack Connectors182
HJH Hip/Jack Connectors ...181, 210
HJHC Hip/Jack Connectors182
HL Light Gauge Purlin Hangers
 102-103
HLBH Beam Hangers ...127, 135-139,
 142-146, 206, 208-209
HLPTA75 Truss Anchor158
HPA Purlin Anchors51-52, 210
HPAHD Foundation Straps47-48
HTA Truss Anchors159-160, 210
HTHJ Hip/Jack Connectors182
HTT Tension Ties42-43
HTW Twist Straps83-84
HTWM Twist Straps85
HUGT Girder Tiedowns166
HUS Slant Nail Hangers ...92, 94-98,
 122-123, 174, 206-207, 210
HWUH Top Flange Hangers ..111-112,
 206, 208-209
ICPL Protection Plates196, 210
ID4 Protection Plate196
IS Insulation Supports203
J Ornamental Hangers100
JA Joist Angles71-72, 210
JDS Purlin Hangers110
JH Multi-Purpose Joist Hangers 105-106
JL Standard Joist Hangers ...91, 94-95
JN Power Nail Hangers205
JN(E) Power Nail Hangers205
JP Purlin Hangers110
JPF Purlin Hangers110
JR Standard Joist Hangers ...91, 94-95
JUS Slant Nail Joist Hangers92,
 94-99, 210
KAG Angle Gussets76
KB Beam & Purlin Hangers101,
 103-105, 206, 209
KCB Column Bases60, 210
KCBQ Column Bases59

KCC Column Caps65-66, 210
KCCC Column Caps65-66
KCCO Column Caps65-66
KCCOB Column Caps65-66
KCCQ Column Caps64
KCCT Column Caps65-66
KECC End Column Caps ..65-66, 210
KECCL End Column Caps65-66
KECCO End Column Caps65-66
KECCQ End Column Caps64
KEG Glulam Beam Hangers150,
 206, 208-209
KF Panel Hangers109
KFHA Strap Ties79-80
KFTA Floor Tie Straps83
KGB Glulam Hangers ...151, 206, 209
KGH Floor Girder Hangers ...39, 206,
 208-209
KGLB Laminated Beam Seats38
KGLBT Laminated Beam Seats ...38
KGLS Glulam Saddle Hangers ...155,
 206, 208-209
KGLST Glulam Saddle Hangers ...155,
 206, 208-209
KGLT Glulam Beam Hangers152,
 206, 208-209
KHB Beam & Purlin Hangers101,
 103-105, 206, 209
KHC Hinge Connectors153-154
KHCT Hinge Connectors153-154
KHCCT Hinge Connectors ...153-154
KHCST/KHCSTR Seismic
 Straps153-154
KHGB Glulam Hangers151, 206,
 209
KHGLB Laminated Beam Seats ...38
KHGLS Glulam Saddle Hangers ...155,
 206, 208-209
KHGLST Glulam Saddle
 Hangers ...155, 206, 208-209
KHGLT Glulam Beam Hangers ...152,
 206, 208-209
KHHB Beam & Purlin Hangers ...101,
 103-105, 206, 209
KHHB Glulam Hangers151, 206,
 209
KHL Heavy Angles75
KHSA Connector Straps86
KHST Strap Ties82
KHW Top Flange Hangers ...102-105,
 206, 208-209
KLB Beam & Purlin Hangers101,
 103, 206, 209
KLCC Lally Column Caps63-64
KLEG Glulam Beam Hangers150,
 206, 208-209
KLFTA Floor Tie Strap83
KMEG Glulam Beam Hangers ...150,
 206, 208-209

New Products

© Copyright 2007 USP Structural Connectors®

KNS1 Protection Plate196
KRPS Strap Ties82, 210
KSA Connector Straps86
KSCT68 Corner Tie204
KST Strap Ties79-81
KSTI Strap Ties79-81
KTS Twist Straps83-84
KVB Knee Braces87
KVBI Knee Braces87
L Straps77, 210
LBH Beam Hangers127,135-146, 206, 208-209
LBP Bearing Plates26, 210
LBPS Bearing Plates26, 210
LDSC4 Drag Strut Connector191
LFTA6 Twist Strap83-84, 210
LH Straps77
LPTA Embedded Truss Anchors .. 157
LS Light Slope Hangers106
LSSH Slope/Skew Hangers148, 206-207, 210
LSTA Strap Ties79-80
LSTAD Foundation Straps49-50
LSTI Strap Ties79-80
LTS Tension Ties42-43
LTTI31 Tension Tie42-43
LTW Twist Straps83-84, 210
LUGT Girder Tiedowns164-165
MB16 Bridging195-196
MBG Bridging195-196
MP Framing Angles71-72, 210
MP34 Framing Angle69-70, 210
MPA1/MPA1F Framing Angles ..69-70, 210
MPAHD Foundation Strap47-48
MP_F Multi-Lateral Plate Ties ..69-70, 210
MPH Masonry Hangers113-114, 128-138, 140-146, 206, 208-209
MRT7 Power Nail Hanger205
MSH Strap Hangers175-178, 210
MSH213L/R Skewed Truss Hanger 178
MSSH217 Skewed Hanger179
MSTA Strap Ties79-80, 210
MSTC Strap Ties79-81
MTHF Power Nail Hangers205
MTS27B Tension Tie42-43
MTW Twist Straps83-84, 210
MUGT15 Girder Tiedown165
N Bridging194
N Nails20-21, 210
NFM Masonry Hangers115, 206, 208-209
NOP Moisture Barrier Plates157
NP Mending Plates204
NPA Mending Plates204
O Bridging194
Ornamental series77
PA Post Anchors55, 210
PA Purlin Anchors51-52, 210

PA(E) Post Anchors55, 210
PAHD42 Foundation Strap47-48
PAI Purlin Anchors51-52
PAT Purlin Anchors51-52
PATM25 Purlin Anchor51-52
PAU Post Anchors55, 210
PB Post Caps62, 210
PBC Post Beam Corner63, 210
PBES Post Caps62, 210
PBS Post Caps62, 210
PC Plywood Clips203
PCM Post Caps61, 210
PCP Plastic Post Caps201
PH Top Flange Hangers128-131, 137, 206, 208-209
PHD Predeflected Holdowns41
PHG Panel Hangers109
PHI I-Joist Top Flange Hangers128-139, 206, 208-209
PHM Top Flange Hangers128-146, 206, 208-209
PHX Top Flange Hangers128-129, 133-146, 206, 208-209
PHXU Top Flange Hangers ..128-131, 135-138, 142-146, 206, 208-209
PL4 Protection Plate196
PRPL Mending Plates204
PRT2 Pipe Rail Tie199, 210
PS Strap Ties82, 210
PWFS24 Wood Foundation Strap ..87
RFUS Uplift Girder Tie163
RP6 Retro Plate39
RS Coiled Strapping78, 210
RSPT Stud Plate Ties73, 210
RT Hurricane/Seismic Anchors167-169, 210
RT Strap Rafter Ties85, 210
RUSC Strap Connector162
RWB Wall Bracing197-198
S01 Holdown Framing Anchor74
S Plywood Clips203
S Wall Bracing197-198
SBP Bearing Plates187
SCA Stair Angles201, 210
SDJT14 Deck Post Tie200, 210
SDPT Deck Post Ties200, 210
SFA Foundation Anchors37
SFC Framing Clips74
SFJA Foundation Anchor37
SFP Fence Post Connectors198
SGP Strap Truss Tiedowns161
SHA Masonry Uplift Connectors ..166
SKH Skewed 45° Hangers ..107-108, 206-207, 210
SKHH Skewed 45° Hangers107-108, 206-207
SMP Fence Post Connectors198
SNP3 Skewed Nail Plate180
SP Speed Prong Hangers ..91, 94-95
Specialty Options206-209

Specification Tools211
SPT Stud Plate Ties73, 210
SPTH Stud Plate Ties73, 210
ST24H Truss Brace & Spacer190
ST Foundation Anchors ...36-37, 210
ST Strap Ties79-80
STAD Foundation Straps49-50
STB Anchor Bolts34-35, 210
STBL Anchor Bolts34-35, 210
STC Scissor Truss Clips186
STS Stud Shoes198
SUH Joist Hangers 91, 94-100, 206-207
SW Top Flange Hangers102-105, 206, 208-209
SWH Top Flange Hangers ...102-105, 206, 208-209
T Hoist Plates202
T Straps77, 210
TA Truss Anchors159-160, 210
TA Foundation Straps50, 210
TAPL Truss Anchors160-161
TAR Truss Anchors159-160
TD Holdowns44-45
TDL Concrete Angles53, 210
TDS Holdowns53
TDX Holdowns44-45, 210
TFI Top Mount Hangers ..126, 132-135, 138-139
TFL Top Mount Hangers .126, 131-134
TH Straps77
THD Face Mount Truss Hangers122-125, 172, 206-207, 210
THDH Face Mount Hangers ..122-125, 173, 206-207
THF Face Mount Hangers121, 123-125, 206-207
THO Top Mount Hangers .126, 130-143
TMP Rafter-To-Plate Connectors ..147
TMPH Rafter-To-Plate Connectors .147
TMU26 Light Slope Hanger ...106, 210
TPP Mending Plates204
TR Roof Truss Ties188
TS Truss Spacer191
TSX Truss Spacers191
UGTS Uplift Girder Ties162-163
UMH Universal Masonry Hangers ..114
UPHD8 Holdown46
USC Uplift Girder Ties162-163
WAS Wet Post Anchors56, 210
WB Wall Bracing197-198
WBC Wall Bracing197-198
WBT Wall Bracing197-198
WE Wet Post Anchors56, 210
WG Concrete Form Wedge35
WS Wood Screws22, 210
WS Wood Screw Applications ..23-25
WT22 Wall Ties202
WUSC Uplift Girder Ties163
ZC Blocking Supports188

New Products

Reference Number Index on next page

About the Reference Numbers

Reference numbers shown throughout the charts in this catalog are part numbers which may be more familiar to customers in various regions of the United States. These are included for the convenience of our new customers who have recently switched from a competitor's product line to USP.

The reference numbers in this catalog are for general application comparison only and should not be used as a substitution tool. The user is responsible to compare specific load values, fastener schedules, material specifications, and other factors to determine suitability of use for any particular product.

A Angle	.53, 71-72, 76
A34, A35 Anchor	.70
AB Post Base	.55
ABE Post Base	.55
ABU Post Base	.55
AC Post Cap	.62
ACE Post Cap	.62
AM Anchormate® Bolt Holder	.32
B Hanger	.103-105, 131, 137-138, 145-146
BC Base	.58
BC Cap	.62
BI Hanger	.135-145
BP Bearing Plate	.26
BT Brick Tie	.202
CB Column Base	.60
CBQ Column Base	.59
CBS Column Base	.59
CBSQ Column Base	.58
CC Column Cap	.65
CCQ Column Cap	.64
CMST Strap	.78
CMSTC Coiled Strap	.78
CPS Composite Standoff	.63
CS Strap	.78
CWB Wall Bracing	.198
DBTZ Deck Tie	.200
DJT Deck Tie	.200
DPT Deck Tie	.200
DS Drywall Stop	.203
DSC Drag Strut Connector	.191
DSP Double Stud Plate	.73
DTC Roof Truss Clip	.188
ECC Column Cap	.65
ECCQ Column Cap	.64
EG Hanger	.150
EPB Post Base	.57
EPC Post Cap	.61
F Hanger	.109
FA Foundation Anchor	.37
FB Fence Bracket	.199
FC Framing Clip	.74
FJA Anchor	.37
FTA Floor Tie Anchor	.83
GB Hanger	.151
GBC Gable Bracing	.169
GH Hanger	.39
GLB Beam Seat	.38
GLBT Beam Seat	.38
GLS Hanger	.155
GLT Hanger	.152
GLTV Hanger	.135-138, 140, 143-146
H Hurricane Ties	.84, 169
HB Hanger	.139
HCA Hinge Connector	.153
HCP Hip Corner Plate	.169
HCST Strap	.154

HDA Holdown	.45
HETA Truss Anchor	.160
HETAL Truss Anchor	.161
HFN Hanger	.109
HGA Gusset Angle	.167
HGAM Gusset Angle	.167
HGB Hanger	.151
HGLB Beam Seat	.38
HGLS Hanger	.155
HGLT Hanger	.152
HGLTV Hanger	.135-138, 143-146
HGT Girder Tiedown	.166
HGUS Hanger	.124-125, 173
HH Hanger	.75
HHB Hanger	.151
HHUS Hanger	.124-125, 172
HIT Hanger	.132-134, 139
HL Angle	.75
HL Tie	.76
HPA Purlin Anchor	.52
HPAHD Holdown	.48
HS Hurricane Tie	.169
HSA Strap	.86
HST Strap	.82
HSUR/HSUL Hanger	.108
HT Tie	.77
HTS Twist Strap	.84
HTSM Twist Strap	.85
HTT Tension Tie	.43
HU Hanger	.94-100, 123-125
HUS Hanger	.94-98, 123, 174
HUTF Hanger	.103-105
HW Hanger	.132-133, 136, 140-141, 144
HWI Hanger	.134, 136-139, 144-146
HWU Hanger	.135-138, 143-146
IS Insulation Support	.203
ITT Hanger	.130-134, 136-138
IUS Hanger	.123
IUT Hanger	.123-124
JB Hanger	.103
L Angle	.72
L Strap Tie	.77
LB Hanger	.103
LBOLT Anchor Bolt	.35
LBP Bearing Plate	.26
LBV Hanger	.139-140
LCB Column Base	.60
LCC Lally Column Cap	.64
LEG Hanger	.150
LFTA Floor Tie Anchor	.83
LGT Girder Tiedown	.165
LPC Post Cap	.62
LS Angle	.71
LSSU Hanger	.148
LSTA Strap Tie	.80
LSTHD Holdown	.49
LSTI Strap Tie	.80
LSU Hanger	.106
LTA Truss Anchor	.157
LTB Bridging	.194
LTP Framing Anchor	.70
LTS Twist Strap	.84
LTT/LTTI Tension Tie	.43
LU Hanger	.94-95
LUS Hanger	.94-99
MAB Mudsill Anchor	.37
MAS Mudsill Anchor	.37
MBHA Masonry Hanger	.115
MEG Hanger	.150
META Truss Anchor	.160
MGT Girder Tiedown	.165
MIT Hanger	.132-138, 140-141
MIU Hanger	.123-125
MMLU Hanger	.205

MP Mending Plate	.204
MST Strap Tie	.81
MSTA Strap Tie	.80
MSTC Strap Tie	.81
MSTI Strap Tie	.81
MTHM Hanger	.182
MTS Twist Strap	.84
MTT Tension Tie	.43
Nails	.20
NC Nailless Bridging	.195
NCA Nailless Bridging	.196
NS Nail Stopper	.196
O Ornamental	.77
PA Holdown	.50
PA/PATM Purlin Anchor	.52
PAHD Holdown	.48
PAI Purlin Anchor	.52
PAT Purlin Anchor	.52
PB Post Base	.56
PBS Post Base	.56
PC Post Cap	.61
PF Hanger	.110
PGT Pipe Tie	.199
PHD Holdown	.41
PS Strap	.82
PSCL Sheathing Clip	.203
PSPNZ Protective Plate	.196
RP Retro Plate	.39
RPS Strap Tie	.82
RSP Stud Plate Tie	.73
S/HD Holdown	.53
SA Strap	.86
SDS Screw	.22-25
SP Stud Plate Tie	.73
SPH Stud Plate Tie	.73
SSP Single Stud Plate	.73
SSTB Anchor Bolt	.35
ST Strap Tie	.80
STC Roof Truss Clip	.188
STHD Holdown	.49
SUR/SUL Hanger	.107-108
T Strap Tie	.77
TA Staircase Angle	.201
TB Tension Bridging	.194
TBE Truss Enhancer	.187
TC Truss Connector	.186
THA Hanger	.176-177
THAC Hanger	.176-177
THAI Hanger	.176-177
THGA Hanger	.183
THGB Hanger	.183
THGBH Hanger	.183
THMA Hanger	.184
TJC37 Truss Connector	.180
TP/TPA Tie Plate	.204
TS Twist Strap	.84
TSB Truss Spacer	.190
TSF Truss Spacer	.191
TSS Truss Seat	.157
TWB Wall Bracing	.198
U Hanger	.94-100, 125
VB Knee Brace	.87
W Hanger	.103-105, 130-131, 133-134, 136-139
W Wedge	.35
WB/WBC Wall Bracing	.198
WM Hanger	.113-114, 130-138, 140, 143-146
WNP Hanger	.103-105
WP Hanger	.130-134, 136-146
WPU Hanger	.131
WT Wedge Form Tie	.35
Z Clip	.188

ADHESIVE & UNDERCUT ANCHORING SYSTEMS..... PAGES 29-31

- **DUC Series**
Ductile Undercut Anchors.
- **CIA-EA**
High strength epoxy acrylate.
- **CIA-GEL 7000**
High strength epoxy.



BOLT-RITE™ PRODUCTS..... PAGES 32-33

- **ABH Series**
Anchor bolt holder.
- **ABHS Series**
Anchor bolt holder with spacer.
- **ABS12**
Anchor bolt stabber for placement in wet concrete.
- **ABC Series**
Anchor bolt caps used with the ABS, ABH, and ABHS series.
- **ABSL Series**
Anchor bolt sleeve to raise anchor bolt embedment lines.
- **FBS**
Form board spacers.

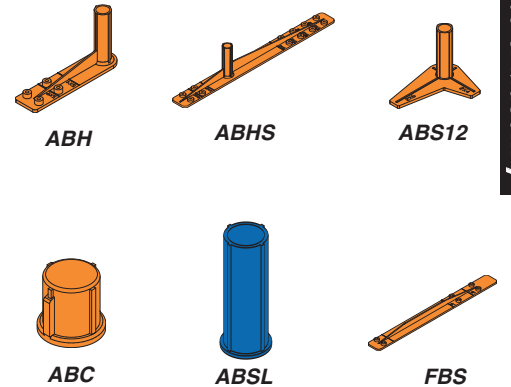

ANCHOR BOLTS PAGES 34-35

- **STB & STBL Series**
USP anchor bolts designed for higher capacity applications.
- **AB Series**
USP anchor bolts designed for general capacity applications.



CONCRETE FORM TIES & WEDGE PAGE 35

- **FT Series**
Low foundation wall tie.
- **WG**
Wedge for FT tie.

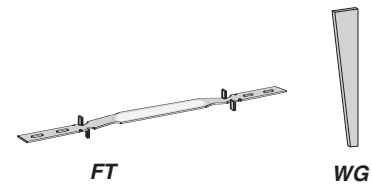

FOUNDATION ANCHORS PAGES 36-37

- **ST Series**
Embedded mudsill anchors.
- **FA3**
Embedded mudsill and stud anchors.
- **SFA & SFJA Series**
Bolted mudsill anchors for retrofit applications.

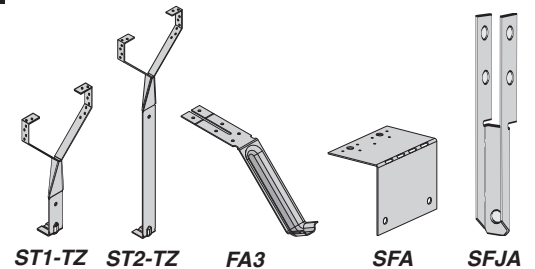

continued on next page

LAMINATED BEAM SEATS..... PAGE 38

- KGLB, KGLBT, & KHGLB Series

Seats for beams bearing on concrete or masonry.

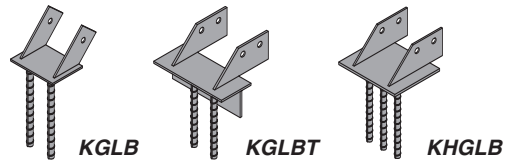

FLOOR GIRDER HANGERS PAGE 39

- KGH Series

Secures girder beam to foundation wall.

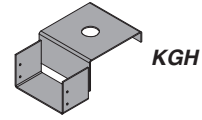

RETRO PLATE..... PAGE 39

- RP6

Oversized plate to distribute forces on masonry surface.



© Copyright 2007 USP Structural Connectors®

Mechanical anchor expanded into a hole that has been undercut at the bottom using an undercutting drill bit creating a true bearing type anchor that performs like a cast-in-place headed anchor. Load is transferred into the concrete through bearing, not friction like traditional expansion anchors. Excellent performance in seismic and dynamic loading conditions. Meets ACI 318-02 Appendix D requirements as a code anchor, including seismic loading, tension zone, and cracked concrete provisions.



DUC Undercut Anchor



DUC UCB Undercut Drill Bit

Rod Materials: ASTM A36 (L Series), A193 Grade B7 (H Series), or AISI 316 Stainless Studs

Anchor Body Materials: ASTM A 513 Type 5, or AISI 316 Stainless

Codes: ICC-ES ESR-1970, L.A. City RR 25113

Installation:

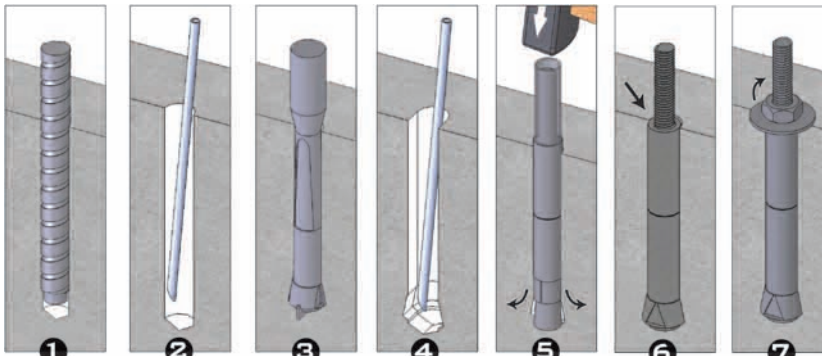

1 Drill the hole to proper depth and diameter per specifications using rotohammer and stop drill.

2 Clean the hole using a blow-out bulb or compressed air.

3 Insert the undercut bit and start the rotohammer. Undercutting is complete when the stopper sleeve is fully compressed (gap closed).

4 Clean the hole again using a blow-out bulb or compressed air.

5 Insert anchor into hole. Place setting sleeve over anchor and drive the expansion sleeve over the expansion coupling.

6 Verify that the setting mark is visible on the threaded rod above the sleeve.

7 Apply proper torque.

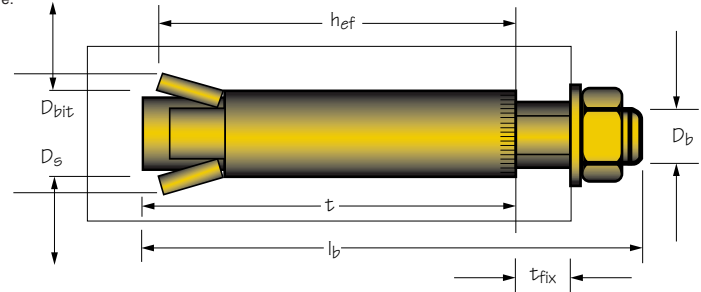

Tension and Shear Capacities for DUC Anchors in $f'_c \geq 2,500$ psi concrete

USP Stock No.	Stud Dia. D(b)	Drill Hole Dia. D(bit)	Drill Hole Depth t	Effective Embedment h(ef)	Overall Length, l(b)	Sleeve length l(s)	Allowable Tensile Capacity, N(s)	Allowable Shear Capacity V(s)				
38-275L	3/8	5/8	3-1/8	2-3/4	6	2-3/4	2087	1043				
38-275LT				4-1/2		4-1/2						
38-400H			4	7-1/2	4	4497			2254			
38-400HT					5-3/4							
12-400L	1/2	3/4	4-3/8	4	7-1/2	4	3821	1909				
12-400LT				5-3/4		5-3/4						
12-500H			5	8-1/2	5	8235			4111			
12-500HT										6-3/4	6-3/4	
12-675H			6-3/4	10-1/4	7-1/8	6-3/4			10-1/4	8-1/2		
12-675HT											8-1/2	8-1/2
58-450L	5/8	1	5-1/8	4-1/2	8-3/8	4-1/2	6086	3047				
58-450LT				6-1/4		6-1/4						
58-750H			7-1/2	11-3/8	8-1/8	7-1/2			11-3/8	7-1/2		
58-750HT											9-1/4	9-1/4
58-900H			9	13	9-5/8	9			13	9	13116	6552
58-900HT												
34-500L	3/4	1-1/8	5-5/8	5	9	5	9007	4497				
34-500LT				6-3/4		6-3/4						
34-1000H			10	14	10-5/8	10			14	10	19411	9692
34-1000HT												

1) Allowable tensile and shear capacities are for anchors installed at standard edge distance and spacing in uncracked concrete in accordance with the 2003 and 2006 IBC (ACI 318-02 and 318-05). For cracked concrete capacities, see the USP Anchoring Systems Design Guide.

CIA-EA – For use in anchoring threaded rod and rebar into normal and lightweight concrete, stemwalls, concrete block, reinforced brick and unreinforced masonry. Bonds to most construction materials. **For use in substrate temperatures above 5° F.**

Materials: 2-component, 100% solids, all weather, moisture insensitive, non-sag, non-shrink, solvent free, high strength epoxy acrylate.

Codes: ICC-ES ESR-1702,
L.A. City RR 25113, FL 4928

Installation:

- Drill hole in concrete or masonry to specified depth and diameter.
- Clean hole completely using compressed air and nylon brush. Dust and debris left in the hole will reduce the holding capacity of the anchor.
- Remove cartridge cap and insert cartridge into dispensing tool. Dispense a small amount of adhesive off to the side to equalize the cartridge.
- Place mixing nozzle (and nut if required) onto cartridge and tighten. Dispense a small amount of adhesive off to the side to ensure proper mixing. Do not use adhesive that is not mixed properly.
- Inject adhesive into the bottom of the hole to avoid air pockets. Fill approximately one half to two thirds full.
- Insert rod into hole while rotating one to two revolutions until the rod contacts the bottom of the hole.



6 oz.
ACR-6



10 oz.
ACR-10

CIA-EA

Shear Capacities for Threaded Rod Installed at a Close Edge Distance for Sill Plates

Rod Diameter (in)	Embed. Depth (in)	Min. Edge Distance (in)	Avg. Ult. Capacity (Lbs.)	Allowable Shear Capacity (Lbs.) ¹	
				100%	133%
3/8	3-3/8	1-3/4	3160	790	1050
1/2	4-1/2	1-3/4	4160	1040	1385
5/8	4-1/2	1-3/4	4160	1040	1385

1) Shear load applied parallel to free edge.

Tension and Shear Capacities for Threaded Rod Installed in Normal Weight Concrete

Rod Diameter (in)	Drill Bit Diameter (in)	Embed. Depth (in)	Tensile Capacity based on Concrete Strength (Lbs.)		Shear Capacity based on Concrete Strength (Lbs.)		Allowable Steel Capacity for A307 (AISI 1018) rod	
			f _c ≥ 2500 psi		f _c ≥ 2500 psi		Tensile (Lbs.)	Shear (Lbs.)
			CIA-EA		CIA-EA			
			Avg. Ult.	Avg. Allow.	Avg. Ult.	Avg. Allow.		
3/8	7/16	3-3/8	6800	1700	5940	1485	2185	1125
1/2	9/16	4-1/2	11580	2895	10240	2560	3885	2000
5/8	11/16	5-5/8	23380	5845	17640	4410	6070	3125
3/4	13/16	6-3/4	28460	7115	25300	6325	8740	4500
7/8	15/16	7-7/8	28460	7115	25300	6325	11900	6130
1	1-1/8	9	44200	11050	40980	10245	15540	8000

- 1) Allowable load must be the lesser of bond or steel strength.
- 2) The tabulated values are for anchors installed at specified spacing (s) and edge (c) distances. Spacing and edge distances may be reduced, reference the Anchoring Systems Technical Guide and/or ICC-ES ESR-1702 for details. Linear interpolation may be used for intermediate spacing and edge distances.
- 3) The tabulated values are for anchors installed in concrete having the designated compressive strength or higher at the time of installation.
- 4) CIA anchors experience a reduction in tensile capacity with increased ambient temperatures. Temperature load factors must be applied when the anchors are installed in locations where the concrete temperatures may exceed 105°F.
- 5) The anchors cannot be used to resist pullout forces in overhead and wall installations, unless proper consideration is given to fire conditions. Reference ICC-ES ESR-1702 for more information.
- 6) Allowable load based on bond strength may be interpolated for compressive strengths between f_c = 2000 psi and f_c = 4000 psi.
- 7) Allowable loads may be increased by 33-1/3% for short term loading due to earthquakes or wind for Allowable Stress Design.
- 8) Bond strength values are based on a safety factor of 4.0.

Cure Times

Substrate Temperature F	CIA-EA	
	Bolt Up Time	Full Cure Time
5° - 10°	12 hrs	36 hrs
11° - 20°	9 hrs	30 hrs
21° - 30°	6 hrs	24 hrs
31° - 40°	4 hrs	12 hrs
41° - 50°	2 hrs	6 hrs
51° - 60°	15 min	70 min
61° - 70°	15 min	60 min
71° - 80°	10 min	30 min
80° - 90°	4 min	25 min



Anchor to Connector Guide

For Applications with USP Holdowns refer to USP Anchor to Connector Guide (USP1017) or visit www.uspconnectors.com

CIA-GEL 7000 – For use in anchoring threaded rod and rebar into normal and lightweight concrete, stemwalls, concrete block, reinforced brick and unreinforced masonry (URM/UMB). Bonds to most construction materials. **For use in substrate temperatures above 40° F.**

Materials: 2-component, 100% solids, 1 to 1 ratio, moisture insensitive, non-sag, non-shrink, solvent free, high strength epoxy.

Codes: ICC-ES ESR-1702, FL 4928, L.A. City RR 25113 & RR 25029

Installation:

- Drill hole in concrete or masonry to specified depth and diameter.
- Clean hole completely using compressed air and nylon brush. Dust and debris left in the hole will reduce the holding capacity of the anchor.
- Remove cartridge cap and insert cartridge into dispensing tool. Dispense a small amount of adhesive off to the side to equalize the cartridge.
- Place mixing nozzle (and nut if required) onto cartridge and tighten. Dispense a small amount of adhesive off to the side to ensure proper mixing. Do not use adhesive that is not mixed properly.
- Inject adhesive into the bottom of the hole to avoid air pockets. Fill approximately one half to two thirds full.
- Insert rod into hole while rotating one to two revolutions until the rod contacts the bottom of the hole.

Tension Capacities for Threaded Rod Installed in Concrete Stemwall Foundations

Rod Diameter (in)	Embed. Depth (in)	Min. Wall Width (in)	Min. Edge Distance (in)	Min. End Distance (in)	Avg. Ult. Capacity (Lbs.)	Allowable Tensile Capacity (Lbs.)	
						100%	133%
5/8	9	5	1-3/4	5	11120	2780	3705
				12	13840	3460	4615
7/8	12-1/4	8	2-3/4	5	19040	4760	6346
				12	23640	5910	7880
7/8	18	12	1-3/4	10	35400	8850	11800
				15	41520	10380	13840

Shear Capacities for Threaded Rod Installed at a Close Edge Distance for Sill Plates

Rod Diameter (in)	Embed. Depth (in)	Minimum Edge Distance (in)	Avg. Ult. Capacity (Lbs.)	Allowable Shear Capacity (Lbs.) ¹	
				100%	133%
1/2	4-1/2	1-3/4	5792	1448	1926
5/8	5-3/4	1-3/4	10800	2700	3600

1) Shear load parallel to free edge.

Tension and Shear Capacities for Threaded Rod Installed in Normal Weight Concrete

Rod Diameter (in)	Drill Bit Diameter (in)	Embed. Depth (in)	Tensile Capacity based on Concrete Strength (Lbs.)		Shear Capacity based on Concrete Strength (Lbs.)		Allowable Steel Capacity for A307 (AISI 1018) rod	
			f _c ≥ 2500 psi		f _c ≥ 2500 psi		Tensile (Lbs.)	Shear (Lbs.)
			CIA-GEL 7000		CIA-GEL 7000			
			Avg. Ult.	Avg. Allow.	Avg. Ult.	Avg. Allow.		
3/8	1/2	1-7/8	4760	1190	--	--	2185	1125
		3-3/8	8600	2150	5880	1470		
1/2	5/8	2-1/2	7760	1940	--	--	3885	2000
		4-1/2	13980	3495	14220	3555		
5/8	3/4	3-1/8	10400	2600	--	--	6070	3125
		5-5/8	21600	5400	19060	4765		
3/4	7/8	3-3/4	15660	3915	--	--	8740	4500
		6-3/4	26740	6685	27620	6905		
7/8	1	7-7/8	33968	8492	34748	8687	11900	6130
1	1-1/4	9	49320	12330	44720	11180	15540	8000

- 1) Allowable load must be the lesser of bond or steel strength.
- 2) The tabulated values are for anchors installed at specified spacing (s) and edge (c) distances. Spacing and edge distances may be reduced, reference the Anchoring Systems Technical Guide and/or ICC-ES ESR-1702 for details. Linear interpolation may be used for intermediate spacing and edge distances.
- 3) The tabulated values are for anchors installed in concrete having the designated compressive strength or higher at the time of installation.
- 4) CIA anchors experience a reduction in tensile capacity with increased ambient temperatures. Temperature load factors must be applied when the anchors are installed in locations where the concrete temperatures may exceed 105°F.
- 5) The anchors cannot be used to resist pullout forces in overhead and wall installations, unless proper consideration is given to fire conditions. Reference ICC-ES ESR-1702 for more information.
- 6) Allowable load based on bond strength may be interpolated for compressive strengths between f_c = 2000 psi and f_c = 4000 psi.
- 7) Allowable loads may be increased by 33-1/3% for short term loading due to earthquakes or wind for Allowable Stress Design.
- 8) Bond strength values are based on a safety factor of 4.0.

Cure Times

Substrate Temperature F	CIA-GEL 7000	
	Bolt Up Time	Full Cure Time
41° - 50°	12 hrs	72 hrs
51° - 60°	8 hrs	48 hrs
61° - 70°	6 hrs	36 hrs
71° - 80°	4 hrs	24 hrs
80° - 90°	4 hrs	24 hrs



10 oz. GEL-10



22 oz. GEL-22

CIA-GEL 7000

Reusable product made of composite plastic that nails to form board and accurately centers the anchor bolt in the sill plate. The ABH is embossed with markings for both 2 x 4 and 2 x 6 sill plates. Product may be used with standard anchor bolts, J-bolts, and USP's STB Anchor Bolts. Use USP's ABSL Anchor Bolt Sleeves for proper anchor bolt embedment depth with 3x sill plates and USP's STB Anchor Bolts. The anchor bolt cap protects the anchor bolt threads during concrete placement.

Materials: Composite Plastic
Finish: See chart
Patents: Pending

Installation:

- Place ABH over anchor bolt and screw on cap.
- Nail ABH to form board using embossing for sill plate width.
- For USP's STB Anchor Bolts, use opening in top of cap to properly align anchor bolt.
- For STB Anchor Bolts, it may be easier to nail ABH to form prior to placing it in the anchor bolt.

USP Stock No. ¹	Ref. No.	Bolt Dia.	Fastener Schedule	Color
ABH12	AM1/2	1/2	(2) 8d	orange
ABH58	AM5/8	5/8	(2) 8d	blue
ABH78	AM7/8	7/8	(2) 8d	green

1) Anchor bolt caps are included with product.

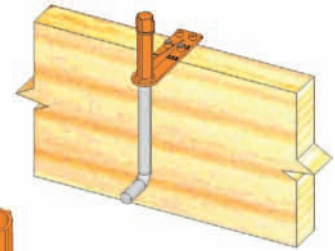

Typical ABH12 installation

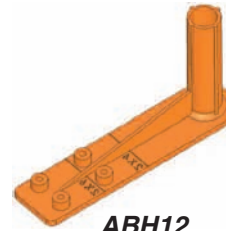

ABH12

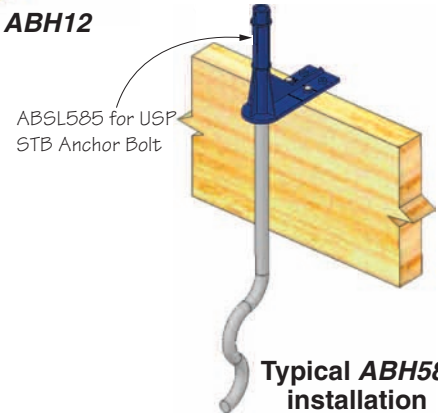

Typical ABH58 installation

ABSL585 for USP STB Anchor Bolt

© Copyright 2007 USP Structural Connectors®

Concrete & Masonry

ANCHOR BOLT HOLDERS WITH SPACERS (BOLT RITE™) – ABHS SERIES

Reusable product made of composite plastic that nails to both form boards of a stemwall while accurately centering the anchor bolt in the sill plate. The ABHS is embossed with markings to center the anchor bolt in both 2 x 4 and 2 x 6 sill plates. In addition, it is embossed with markings to accurately space form boards for both 6" and 8" stemwalls. Use USP's ABSL Anchor Bolt Sleeves for proper anchor bolt embedment depth with 3x sill plates and USP's STB Anchor Bolts. The anchor bolt cap protects the anchor bolt threads during concrete placement.

Materials: Composite Plastic
Finish: See chart
Patents: Pending

Installation:

Anchor Bolt Installation:

- Place ABHS over anchor bolt and screw on cap.
- Nail ABHS to form board using embossing for sill plate width.
- For USP's STB Anchor Bolts, use opening in top cap to properly align anchor bolt.

ABHS Series Installation:

- Nail short side of ABHS to form board aligning the sill plate width marking with the inside of the form board.
- Nail the longer side of the ABHS to the form board aligning the stemwall width and sill plate embossing with the inside face of the form board.

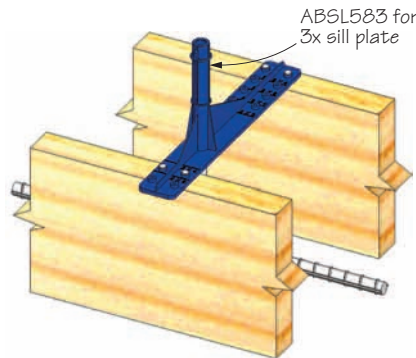

Typical ABHS58 installation

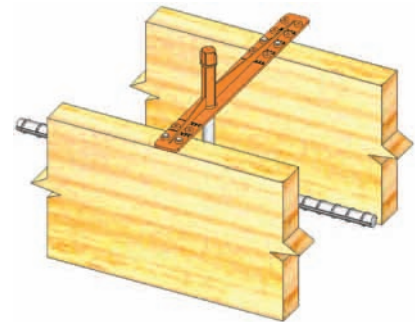

Typical ABHS12 installation

USP Stock No. ¹	Ref. No.	Bolt Dia.	Fastener Schedule	Color
ABHS12	---	1/2	(4) 8d	orange
ABHS58	---	5/8	(4) 8d	blue
ABHS78	---	7/8	(4) 8d	green

1) Anchor bolt caps are included with product.



ABHS12

ANCHOR BOLT STABBER (BOLT RITE™) – ABS12



For accurate placement of 1/2" anchor bolts in wet concrete. The outstanding legs are different lengths, with the shorter leg centering the anchor bolt in a 2 x 4 sill plate and the longer leg centering the anchor bolt in a 2 x 6 sill plate.

Materials: Composite Plastic
Finish: See chart
Patents: Pending

Installation:

- Slide ABS over anchor bolt and screw on cap.
- Place bolt in wet concrete using guides for proper edge distance.

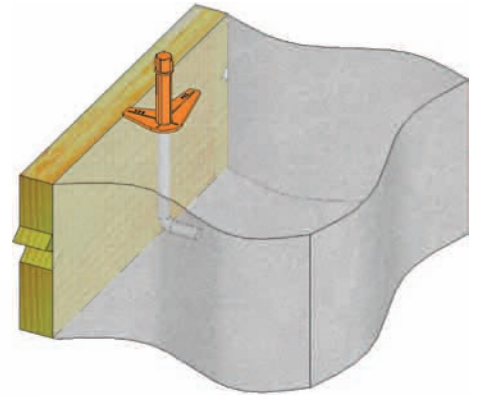

Typical ABS12 installation

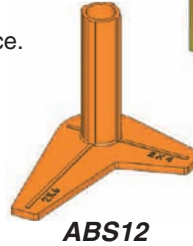

ABS12

USP Stock No. ¹	Ref. No.	Bolt Dia.	Color
ABS12	--	1/2	orange

1) Anchor bolt caps are included with product

ANCHOR BOLT CAPS & SLEEVES (BOLT RITE™) – ABC & ABSL SERIES

ABC – Designed to be used with the ABS, ABH, and ABHS and protect the threads of the anchor bolt during concrete placement. The 5/8" and 7/8" caps have open tops to see the identification stamp and alignment indicator of the USP's STB Anchor Bolt.

ABSL – Anchor Bolt Sleeves used to raise the embedment of the anchor bolt. Used with 3x sill plates and USP's STB Anchor Bolts.

USP Stock No.	Ref. No.	Bolt Dia.	L	Color	Sleeve Application
ABC12	---	1/2	---	orange	---
ABC58	---	5/8	---	blue	---
ABC78	---	7/8	---	green	---
ABSL583	---	5/8	3/4	blue	3x sill plate
ABSL585	---	5/8	1-7/8	blue	STB Anchor Bolt
ABSL5867	---	5/8	3-9/16	blue	STBL Anchor Bolt
ABSL783	---	7/8	13/16	green	3x sill plate
ABSL785	---	7/8	1-3/4	green	STB Anchor Bolt
ABSL7867	---	7/8	3-1/2	green	STBL Anchor Bolt

Materials: Composite Plastic
Finish: See chart
Patents: Pending

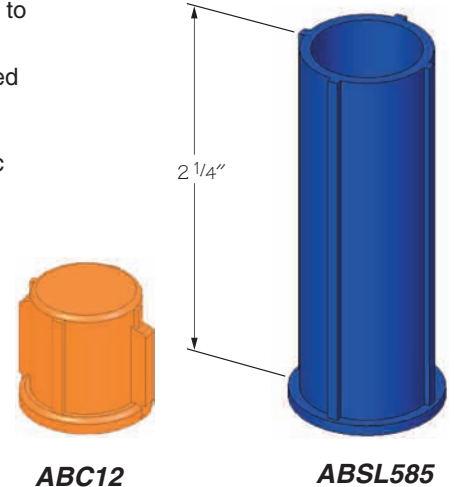

ABC12

ABSL585

FORM BOARD SPACER (BOLT RITE™) – FBS

Reusable product made of composite plastic that accurately holds form boards for 6" and 8" stemwalls. Embossed markings ensure accurate placement.

Materials: Composite Plastic
Finish: See chart
Patents: Pending

Installation:

- Nail FBS to form board aligning single line with inside face of form board.
- Nail other end of FBS to form board at desired stemwall thickness.



FBS

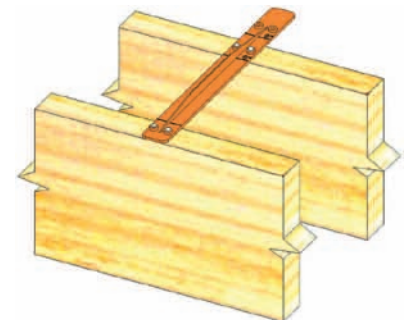

Typical FBS installation

USP Stock No.	Ref. No.	Fastener Schedule	Color
FBS	--	(4) 8d	orange

Embossed ends provide guides for embedment angle and depth. An embedment line is embossed on the shaft for easy installation. Features rolled threads for high tensile strength.

STB – For monolithic slabs and double pour concrete installations.

STBL – Designed for use with 3x sill plates. Excellent choice for use with taller holdown washers like those in the PHD series.

Materials: ASTM A 36 steel, also conforms to ASTM F 1554 and ASTM A 307 requirements for bolts

Finish: None

Options: STB and STBL models are available in Hot-dip galvanized. To order, add *HDG* to end of stock number, as in **STB16-HDG**.

Codes: ICBO 5321, L.A. City RR 25325

Installation:

- Select appropriate STB or STBL Anchor Bolt.
- Use concrete with minimum compressive strength of 2,500 psi at 28 days.
- Minimum center-to-center spacing between bolts is 2(E) for anchors acting simultaneously in tension.
- Match embedment depth with embedment line on the STB or STBL shaft.
- The STB or STBL does not need to be tied to the rebar.
- Nuts and washers are not included.
- Use Bolt-Rite™ products to hold anchor bolt in place during installation.

Monolithic or Double Pour Foundations – Prior to pour, install the STB or STBL in an upright position and at a 45° angle to the wall. Install one horizontal #4 rebar at a depth of 4" (minimum). (See illustrations.)

Concrete Block Applications – Prior to cell pour, install the STB or STBL in an upright position and at a 45° angle to the wall. (See illustrations.) Use the embossed angle guide on the end of the STB or STBL shaft as a guide. Install one horizontal #4 rebar at a depth of 4" and one vertical #4 rebar maximum 48" o.c. spacing. Fill all cells with concrete having a minimum 2,000 psi compressive strength.

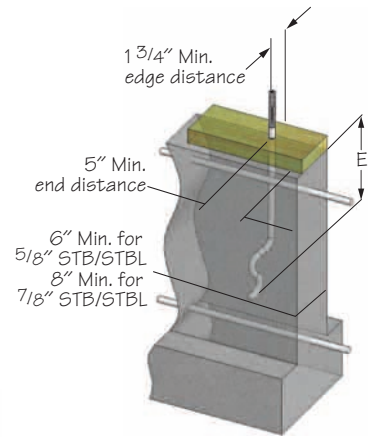

Typical STB/STBL mono pour installation

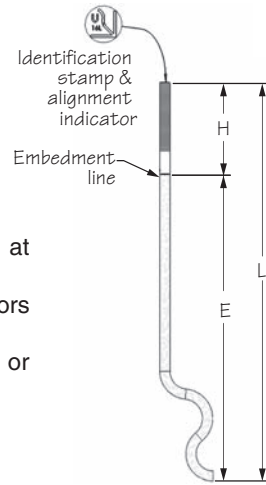

STB/STBL

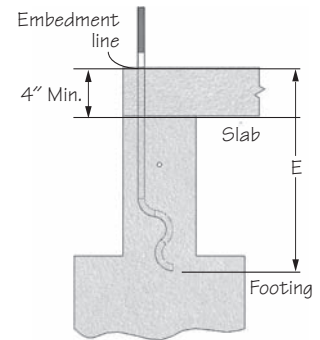

Typical double pour installation

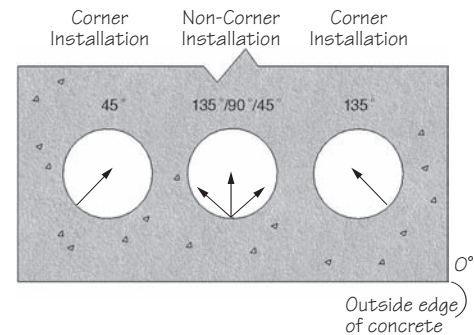

Plan view of STB/STBL placement in concrete stemwall

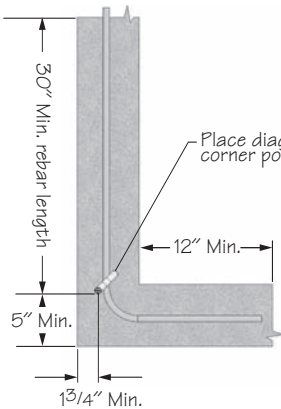

Plan View of Corner installation

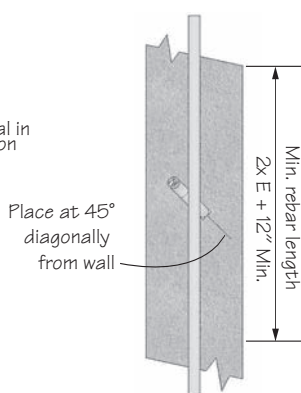

Plan View of Continuous stem wall installation

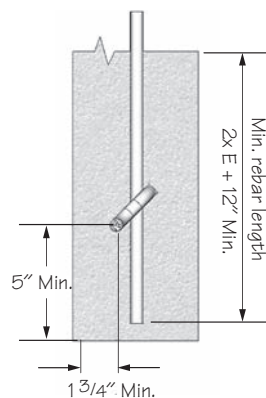

Plan View of End wall installation

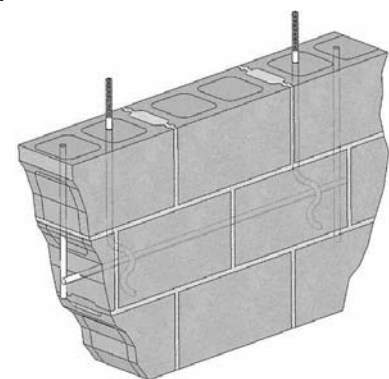

Typical STB/STBL concrete block installation

continued on next page

Anchor Bolt Selection table

USP Stock No.	Ref. No.	2x, 3x, (2) 2x Sill Plates ¹	
		Mono Pour	Double Pour
PHD2	PHD2-SDS3	STB16 STBL16	STB20 STBL20
TDX2	HD2A		
LTS20B	LTT20B		
HTT16	HTT16	STB20 STBL20	STB24 STBL24
PHD5	PHD5-SDS3		
TDX5 *	HD5A		
MTS27B	MTT28B	STB24 STBL24	---
HTT22	HTT22		
PHD6	PHD6-SDS3		
PHD8	---	STB28 STBL28	STB34 STBL34
UPHD8	---		
TDX6	HD6A		
TDX8	HD8A		
TDX10	HD10A		
HTT30	---		
HTT50	---		

* Recommend installation of washer under nut of anchor bolt.
 1) STBL model are recommended for use with PHD and UPHD8 holdowns on (2) 2x and 3x sill plates.

USP Stock No.	Ref. No.	Bolt Dia.	Dimensions			Allowable Tension Load ^{1,2,3}			
			L	H	Min. Embed. (E)	Concrete ⁵		Concrete Block ⁸	
						Minimum End Distance ⁶		Minimum End Distance ⁶	
						5" from end	24" from end	5" from end	11" or > from end
		Wind / Seismic	Wind / Seismic	Wind / Seismic	Wind / Seismic				
STB16	SSTB16	5/8	17-13/16	5	12-13/16	5215	5215	1850	4315
STB20	SSTB20	5/8	21-13/16	5	16-13/16	5215	5215	1850	4315
STB24	SSTB24	5/8	25-13/16	5	20-13/16	5215	5215	1850	4315
STB28	SSTB28	7/8	31	5	26	9335	10425	---	---
STB34	SSTB34	7/8	36	6	30	9335	10425	---	---
STB36	SSTB36	7/8	38	8	30	9335	10425	---	---
STBL16	SSTB16L	5/8	19-9/16	6-3/4	12-13/16	5215	5215	1850	4315
STBL20	SSTB20L	5/8	23-9/16	6-3/4	16-13/16	5215	5215	1850	4315
STBL24	SSTB24L	5/8	27-9/16	6-3/4	20-13/16	5215	5215	1850	4315
STBL28	SSTB28L	7/8	32-3/4	6-3/4	26	9335	10425	---	---
STBL34	---	7/8	36-3/4	6-3/4	30	9335	10425	---	---

- Design loads are based on the average ultimate, from a series of five tests, with a safety factor of three.
- Loads may not be increased for short term loading. Loads apply to wind and seismic loading per 1997 U.B.C.
- Minimum center to center spacing between bolts is 2(E) for anchors acting in tension.
- Minimum edge distance is 1-3/4".
- Concrete stemwall shall be a minimum of 6" thick for 5/8" anchor bolts and 8" for 7/8" anchor bolts.
- End distance shall be no less than 5".
- Connection is limited by lowest of bolt or holdown capacity.
- Concrete block shall be minimum 10" block.

ANCHOR BOLTS – AB SERIES

Materials: Bolt: ASTM F 1554,
 Nut: ASTM A 563,
 Washers: ASTM F 844
Finish: None

The codes specify a minimum diameter and embedment into masonry or concrete for anchor bolts used in foundation plates or sills.
IRC R403.1.6, IBC 2308.6, UBC 1806.6.

Installation:

- Select appropriate AB Anchor Bolt.
- Use concrete with minimum compressive strength of 2,000 psi at 28 days.
- Nuts and washers are included.
- Anchor bolts intended for use to satisfy code prescribed anchoring of mudsill plates, and shall be installed as defined in the code.
- Allowable loads shall be derived in accordance with the code.

USP Stock No.	Ref. No.	Bolt Dia.	L
AB126-HDG	LBOLT50600HDG	1/2	6
AB128-HDG	LBOLT50800HDG	1/2	8
AB1212-HDG	LBOLT50120HDG	1/2	12
AB1218-HDG	LBOLT50180HDG	1/2	12
AB5817-HDG	---	5/8	17

New products or updated product information are designated in red.

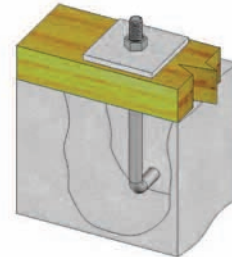

Typical AB128 installation

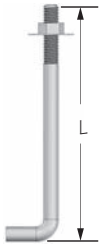

AB128

CONCRETE FORM TIES & WEDGE – FT SERIES & WG

FT – Connect 1x and 2x nominal form lumber in low foundation walls up to 4 feet high.

WG – V-shaped wedge assures rigidity and consistent form spacing.

Materials: FT – 18 gauge, WG – 14 gauge
Finish: G90 galvanizing

Installation:

- Use the Spacing Guide chart to determine spacing between FT units. Each level in chart assumes 12" form boards. Wall thickness from 6" to 12".
- Install with "V" facing up.
- Use (2) WG wedges for each tie. Insert wedge into inside slots for 1x nominal forms and outside slots for 2x nominal forms.
- No walers or stiff-backs are used.
- Vertical ties to keep forms from separating are not included.
- Form deflection may be substantial. Check deflection, if it is critical, and move ties to compensate.
- Forming lumber is assumed to have fb of 1,000 psi.
- Not recommended for pours greater than 4 feet in height.**

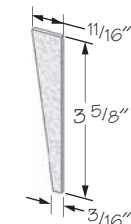

WG Wedge must order separately

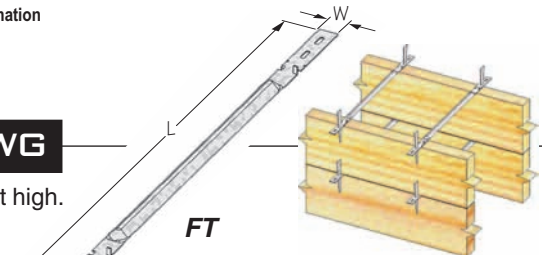

Typical FT/WG installation

Spacing Guide chart

Concrete Lift Height	Level 1		Level 2		Level 3		Level 4	
	1x	2x	1x	2x	1x	2x	1x	2x
12" or Less	2' 6"	4' 0"	---	---	---	---	---	---
12" - 24"	1' 6"	3' 0"	2' 6"	4' 0"	---	---	---	---
24" - 36"	1' 0"	2' 0"	1' 6"	3' 0"	2' 6"	4' 0"	---	---
36" - 48"	0' 9"	1' 6"	1' 0"	2' 0"	1' 6"	3' 0"	2' 6"	4' 0"

1) Factor of safety against tensile failure of tie is 1.5 or more.

USP Stock No.	Ref. No.	Steel Gauge	Dimensions		Wedge	Footing Width or Wall Thickness
			W	L		
FT6	WT6	18	5/8	10-5/8	(2) WG	6
FT8	WT8	18	5/8	12-5/8	(2) WG	8
FT10	WT10	18	5/8	14-5/8	(2) WG	10
FT12	WT12	18	5/8	16-5/8	(2) WG	12
FT14	---	18	5/8	19	(2) WG	14
FT16	---	18	5/8	21	(2) WG	16
WG	W1	14	11/16	3-5/8	---	---

- May be used with either 3/4" or 1-1/2" forming materials.
- Breaking strength is approximately 775 pounds. Space as necessary to prevent form blow-out.

FA3 – For installation into concrete slabs. The FA3 features a split flange for nailing to both mudsill and stud for greater framing versatility.

ST1-TZ – For installation into concrete slab or poured stemwalls. Both models feature a prebent base flange to assure proper anchoring into concrete. **For concrete/masonry installations, refer to the FA & ST Foundation Anchors Technical Bulletin.**

ST2-TZ – For installation into concrete slab, poured stemwalls or concrete masonry. Both models feature a prebent base flange to assure proper anchoring into concrete. **Do not use in red clay brick.**

Materials: See chart

Finish: G90 galvanizing

Options: FA3 is available in Triple Zinc.

To order, add TZ to end of stock number, as in **FA3-TZ**.

Codes: NER 530, FL822, L.A. City RR 25337

Installation:

- Use all specified fasteners. See Product Notes, page 16.
- Use a minimum of two anchors per mudsill. An anchor should always be within 12" of the end of each mudsill section. Follow spacing guidelines in chart.
- Do not rely on these anchors to secure concrete sections together between cold joints.
- For **FA3** insert into wet concrete (minimum strength of 2,000 psi). Place mudsill after concrete cures. Secure flanges to sill (and stud, if applicable), bending flanges as needed to achieve a tight fit. Fasten as directed in chart.
- For **ST1-TZ** and **ST2-TZ** spread sill flanges to mudsill width prior to insertion into wet concrete (minimum strength of 2,000 psi). Alternate installation is possible by inserting unbent flanges through 3/4" center hole predrilled in mudsill. Foundation anchors may also be attached to mudsill and then inserted into wet concrete. When installing **ST2-TZ** into concrete block, fill cells with grout with a minimum strength of 2,000 psi. Concrete block edges may need to be beveled to facilitate installation.
- For additional installation details and information on mudsill anchors refer to **ST** Foundation Anchors Technical Bulletin.
- **ST2-TZ** in masonry construction shall be installed in the core of the block and grouted with concrete grout designed for that purpose. In no case, shall they be installed in a mortar joint.

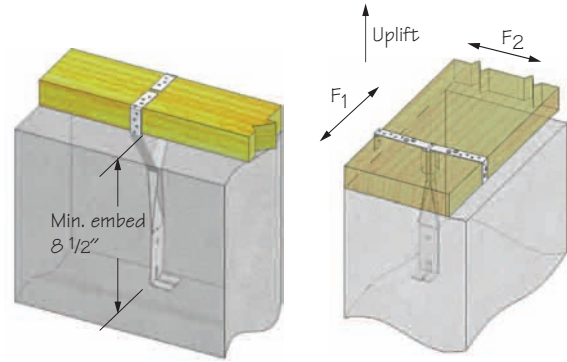

**Typical
ST1-TZ
installation
in concrete**

**Alternate
ST1-TZ
installation with
3/4" center hole**

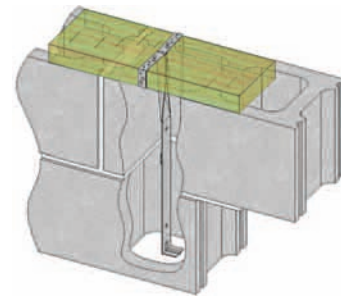

**Alternate
ST2-TZ
installation with
3/4" center hole
in mudsill**

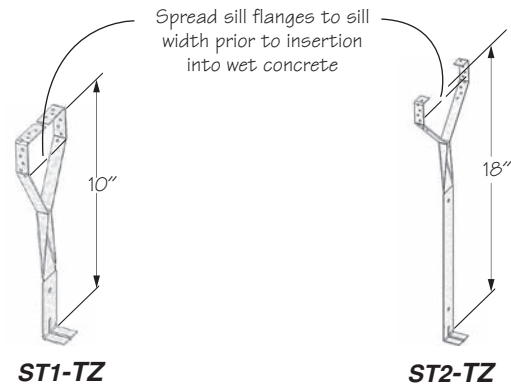

ST1-TZ

ST2-TZ

**DO NOT install
ST1-TZ and ST2-TZ
without pre-bending
sill flanges in "Y"
configuration**

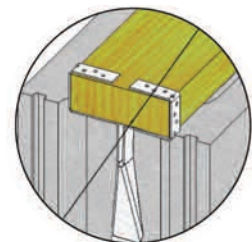

continued on next page

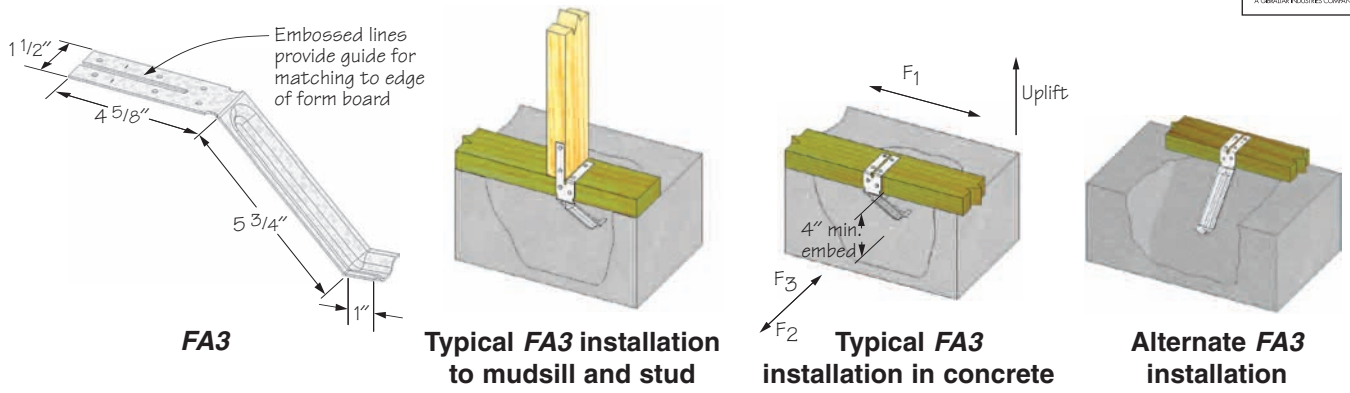
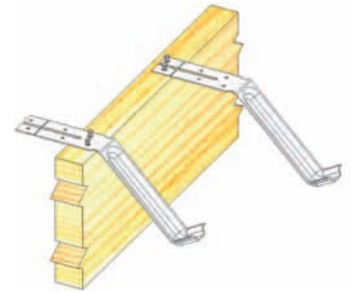

Plate Size	USP Stock No.	Ref. No.	Steel Gauge	Fastener Schedule ²				Min. Embed. ⁴ (E)	Max. Spacing ³ (Feet)	Allowable Loads (Lbs.) ¹							
				Mudsill Top	Mudsill Side	DF-L / SP											
						F1				F2		F3		Uplift			
133%	160%	133%	160%	133%	160%	133%	160%										
2 x 4 - 6	ST1-TZ	MAB15Z	18	(4) 8d x 1-1/2	(4) 8d x 1-1/2	8-1/2"	*5-1/2	565	565	670	745	670	745	825	825		
2 x 4 - 6	ST2-TZ	MAB23Z	18	(4) 8d x 1-1/2	(4) 8d x 1-1/2	16-1/2"	*5-1/2	565	565	670	745	670	745	825	825		
2 x 4 - 6 - 8	FA3	MAS	16	(4) 10d x 1-1/2	(2) 10d x 1-1/2	4"	5-1/2	840	840	705	705	735	750	1155	1155		

- 1) Allowable loads have been increased 33-1/3% or 60% for wind or seismic loads; no further increase shall be permitted.
 - 2) 10d x 1-1/2 nails are 9 gauge (0.148" diameter) by 1-1/2" long.
8d x 1-1/2 nails are 11 gauge (0.131" diameter) by 1-1/2" long.
 - 3) Anchor spacing and design loads assume treated Douglas Fir-Larch with Fc perpendicular @ 625 psi; replaces code prescribed 1/2" anchor bolt with standard washer, spaced 6 ft. on center.
 - 4) If installed in the alternate configuration, the ST1-TZ shall be embedded 11" and ST2-TZ 19".
- *When a 2 x 8 mudsill is used for ST1-TZ or ST2-TZ, maximum spacing is 3 feet unless alternate installation is used.



FA3 Form board installation

FOUNDATION ANCHORS – SFA & SFJA SERIES

SFA – Mudsill anchors for retrofit applications. Features a slotted bend line for easy field adjustment when foundation walls are slanted.

SFJA – Ties floor joists directly to foundations with bolt fastening.

Materials: 12 gauge
Finish: G90 galvanizing

Installation:

- Use all specified fasteners. See Product Notes, page 16.
- A design professional must specify anchor bolt type, length, and embedment. Anchor bolts are laterally loaded. See pages 30 & 31 for CIA-EA or CIA-GEL 7000 for epoxy information.
- Allowable loads assume a minimum concrete compressive strength of 2,000 psi.

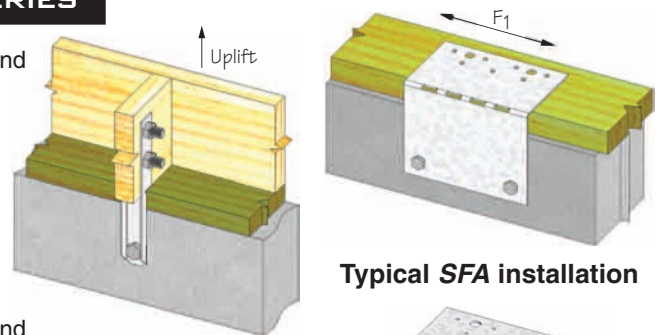

Typical SFJA installation

Typical SFA installation

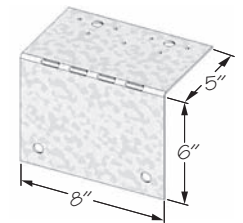

SFA6

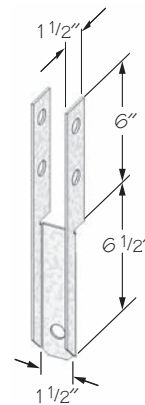

SFJA

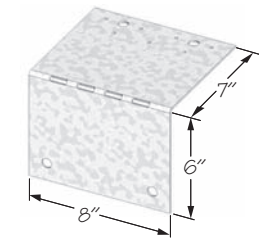

SFA8

USP Stock No.	Ref. No.	Steel Gauge	Anchor Bolts	Fastener Schedule		Allowable Loads (Lbs.) ¹			
				Nails ²	Bolts	DF-L / SP			
						F1		Uplift	
133%	160%	133%	160%						
SFJA	FJA	12	(1) 5/8	---	(2) 5/8	---	---	1305	1305
SFA6	FA6	12	(2) 1/2	(7) 10d x 1-1/2	---	---	875	875	---
SFA8	FA8	12	(2) 1/2	(7) 10d x 1-1/2	---	---	875	875	---

- 1) Allowable loads have been increased 33-1/3% or 60% for wind or seismic loads; no further increase shall be permitted.
- 2) 10d x 1-1/2 nails are 9 gauge (0.148" diameter) by 1-1/2" long.

KGLB – Single bolt, bearing only.

KGLBT – Double bolt with Structural Tee provides uplift and horizontal resistance.

KHGLB – Double bolt design provides uplift and horizontal resistance.

Materials: Flanges – 1/4" steel
Bearing Plate – See chart
Anchor dowels – 3/4" x 12" rebar

Finish: USP primer

Options: Consult USP for non-catalog variations.

Codes: ICBO 2725, L.A. City RR 25104

Installation:

- Use all specified fasteners. See Product Notes, page 16.
- Bolt holes shall be a minimum of 1/32" to a maximum of 1/16" larger than the bolt diameter.
- Concrete or masonry walls must be checked by a design professional for adequacy to resist lateral or uplift loads transferred from the beam seat anchor.

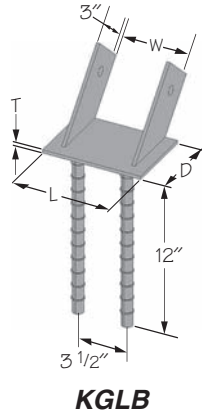

KGLB

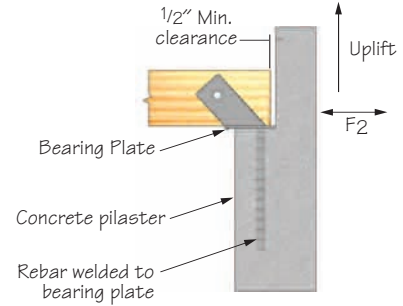

Typical KGLB installation

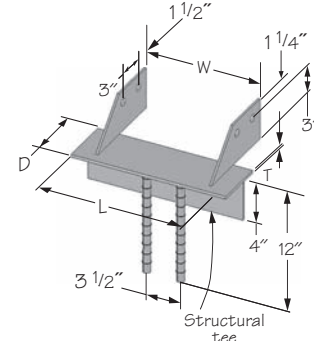

KGLBT

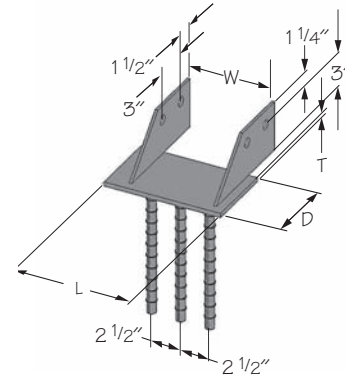

KHGLB

USP Stock No.	Ref. No.	Dimensions				Bolt Schedule	Allowable Bearing Loads (Lbs.) ^{1,4,5}	
		W	L	T	D		Masonry @ 375 psi ²	Concrete ³
KGLB5A	GLB5A	5-1/4	7	1/4	5	(1) 5/8	11790	11790
KGLB5B	GLB5B	5-1/4	7	3/8	6	(1) 5/8	14145	14145
KGLB5C	GLB5C	5-1/4	7	3/8	7	(1) 5/8	16505	16505
KGLB5D	GLB5D	5-1/4	7	3/8	8	(1) 5/8	18860	18860
KGLB7A	GLB7A	6-7/8	9	1/4	5	(1) 3/4	15525	15525
KGLB7B	GLB7B	6-7/8	9	3/8	6	(1) 3/4	18630	18630
KGLB7C	GLB7C	6-7/8	9	3/8	7	(1) 3/4	21735	21735
KGLB7D	GLB7D	6-7/8	9	3/8	8	(1) 3/4	24840	24840

- 1) Beams must fully bear on plates.
- 2) The loads are based on the bearing value listed times the bearing area equal to W x D.
(Note that full bearing plate area is not used.) Bearing loads shall be reduced where limited by wood bearing on the plate.
- 3) The loads on concrete are based on allowable wood bearing stress perpendicular to the grain of 460 psi and actual beam width times beam bearing length.
- 4) Designer shall specify minimum edge and spacing requirements in masonry or concrete structure.
- 5) Concrete or masonry support structure is assumed adequate to support loads listed.

USP Stock No.	Ref. No.	Dimensions				Bolt Schedule	Allowable Bearing Loads (Lbs.) ^{1,5}				F2 ⁴		Uplift ³		
		Range W	D	L	T		Masonry @ 375 psi	On Concrete with Beam Width ²				133%	160%	Min. 3-1/8 Beam Width (W)	
								5-1/8	6-3/4	8-3/4	10-3/4			133%	160%
KHGLBA	HGLBA	3-1/4 to 9	5	10	3/8	(2) 3/4	18750	11790	15525	20125	---	8745	9870	3255	3905
KHGLBB	HGLBB	3-1/4 to 9	6	10	3/8	(2) 3/4	22500	14145	18630	24150	---	8745	9870	3255	3905
KHGLBC	HGLBC	3-1/4 to 9	7	10	3/8	(2) 3/4	26250	16505	21735	28175	---	8745	9870	3255	3905
KHGLBD	HGLBD	3-1/4 to 9	8	10	3/8	(2) 3/4	30000	18860	24840	32200	---	8745	9870	3255	3905
KGLBT512	GLBT512	3-1/4 to 11	5-1/4	12	5/16	(2) 3/4	24750	12965	17080	22140	27200	8745	9870	3255	3905
KGLBT612	GLBT612	3-1/4 to 11	6-1/2	12	3/8	(2) 3/4	29250	15325	20185	26165	32145	8745	9870	3255	3905
KGLBT516	GLBT516	3-1/4 to 15	5-1/4	16	5/16	(2) 3/4	27200	12965	17080	22140	27200	8745	9870	3255	3905
KGLBT616	GLBT616	3-1/4 to 15	6-1/2	16	3/8	(2) 3/4	32145	15325	20185	26165	32145	8745	9870	3255	3905
KGLBT520	GLBT520	3-1/4 to 19	5-1/4	20	5/16	(2) 3/4	27200	12965	17080	22140	27200	8745	9870	3255	3905
KGLBT620	GLBT620	3-1/4 to 19	6-1/2	20	3/8	(2) 3/4	32145	15325	20185	26165	32145	8745	9870	3255	3905

- 1) Beams must fully bear on plates.
- 2) The loads on concrete are based on allowable wood bearing stress perpendicular to the grain of 460 psi and actual beam width times beam bearing length.
- 3) Allowable loads have been increased 33-1/3% and 60% for wind or seismic loads and are based on bolt in wood values only.
Loads assume concrete or masonry structure is adequate to resist loads in those directions.
- 4) Loads must be reduced if the allowable lateral load (F2) for masonry or concrete column governs.
- 5) Designer shall specify minimum edge and spacing requirements in masonry or concrete structure.

Bolts must be ordered separately. See page 26 for available sizes.

Connects girder beams to foundation walls and eliminates the need to block out pockets or inserts while forming foundation.

- Materials:** 12 gauge
- Finish:** USP primer
- Options:** Consult USP for non-catalog design variations.
- Codes:** ICBO 2725, L.A. City RR 25104

Installation:

- Use all specified fasteners. See Product Notes, page 16.
- H dimension assumes 2x mudsill. For 3x or larger mudsill, please contact factory.
- The 1 1/2" hole, centered in the saddle, allows for installation over any protruding foundation bolts. This is not required.
- Placement of a wood sill over the top of the KGH top flange is required to achieve allowable loads.

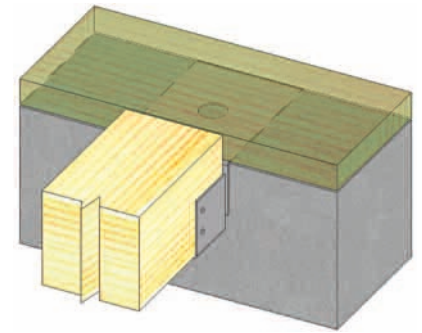

Typical KGH installation

Concrete & Masonry

Girder Size	USP Stock No.	Ref. No.	Steel Gauge	Dimensions					Fastener Schedule ¹	Allowable Loads (Lbs.)	
				W	L	D	S	H		DF-L / SP	125%
4 x 6	KGH46-6	GH46-6	12	3-9/16	5	3-1/4	6	4	(4) 16d	2035	2035
4 x 6	KGH46-8	GH46-8	12	3-9/16	5	3-1/4	8	4	(4) 16d	2035	2035
4 x 8	KGH48-6	GH48-6	12	3-9/16	5	3-1/4	6	6	(4) 16d	2035	2035
4 x 8	KGH48-8	GH48-8	12	3-9/16	5	3-1/4	8	6	(4) 16d	2035	2035
6 x 6	KGH66-6	GH66-6	12	5-1/2	6-1/4	3-1/4	6	4	(4) 16d	2035	2035
6 x 6	KGH66-8	GH66-8	12	5-1/2	6-1/4	3-1/4	8	4	(4) 16d	2035	2035
6 x 8	KGH68-6	GH68-6	12	5-1/2	6-1/4	3-1/4	6	6	(4) 16d	2035	2035
6 x 8	KGH68-8	GH68-8	12	5-1/2	6-1/4	3-1/4	8	6	(4) 16d	2035	2035

1) Minimum header thickness shall be 1-5/8" for 16d nails.

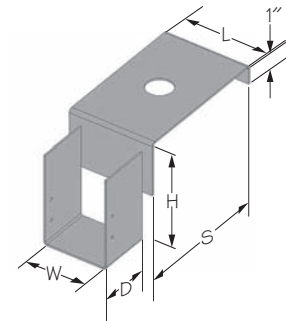

KGH

Specialty Options Chart – refer to Specialty Options pages 206 to 209 for additional details.

Option	Skewed ^{1,2}	Saddle
Range	1" to 45"	--
Allowable Loads	100% of table load.	100% of table load per side.
Ordering	Add SK, angle required, and right (R) or left (L), to product number. Ex. KGH46-6SK45R	Add SA, and saddle width required to product number. Ex. KGH46-6SA=5-1/2"

1) Skewed hangers with skews greater than 15° may have all joist nailing on outside flange.
2) Skewed hangers with skews greater than 15° require the joist end to be bevel cut.

RETRO PLATE – RP6

Uses heavy gauge HRPO steel and a large surface area to distribute seismic forces on masonry exteriors.

- Materials:** 3/8" plate
- Finish:** USP primer

Installation:

- Install with a 3/4" diameter steel threaded rod.

USP Stock No.	Ref. No.
RP6	RP6

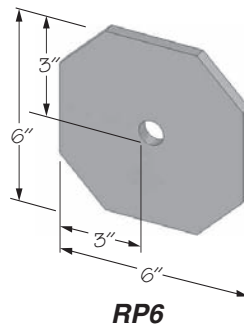

RP6

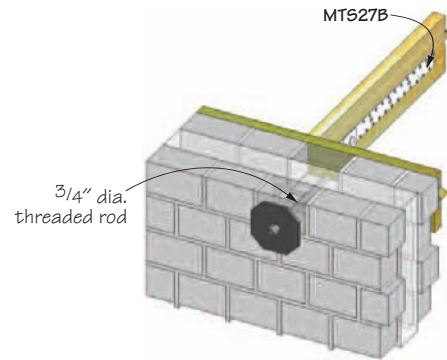

Typical RP6 installation