

The WS Wood Screw is a self-drilling screw used for numerous framing applications. This screw features a reverse locking serration on the bottom of the screw head to help prevent over tightening against a steel plate. The USP head stamp identifies screws for easy inspection.

Screw shear capacities are based on a diameter of 0.242" when the shear plane is on the screw shank (SH) and 0.185" when the shear plane is on the knurl or threads (T). USP WS Wood Screws have a bending yield strength of 217,000 psi. For conditions not charted here, screw loads may be calculated as shown in the NDS® and increased for duration of load.

**Materials:** 1/4" diameter Grade 5 steel  
**Finish:** See chart  
**Codes:** ICBO 5634, L.A.City RR 25433

**Installation:**

- Screws are self-drilling.
- Install using a low speed clutch drill with 3/8" hex head driver. The washer head should be flat to the surface and the serrations will oppose turning and release the clutch. Do not over-tighten the screws.
- Installing the screw at an angle may introduce additional bending and tension forces into the fastener if the screw head is not flat on the bearing surface. Care should be given to ensure the fastener is installed perpendicular to the plane of the side plate.

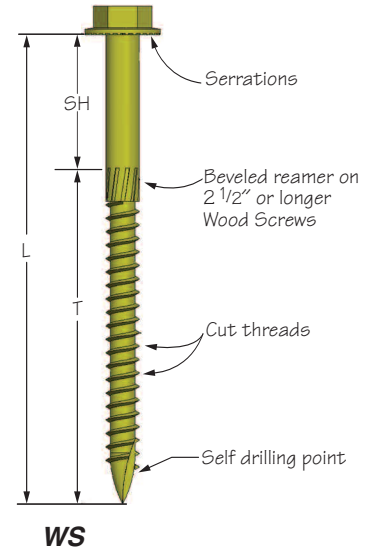

© Copyright 2007 USP Structural Connectors®

**For Attaching Multi-Ply Wood Trusses or LVL or PSL members, or floor trusses, see pages 23-25.**

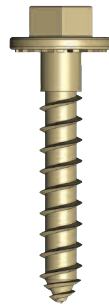

**AVAILABLE IN  
GOLD  
COAT**

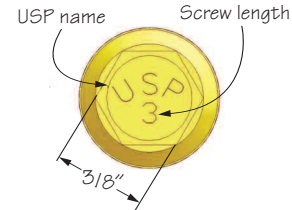

USP Stock No.	Ref. No.	Description	Dimensions				Finish <sup>1,5</sup>	DF-L / SP <sup>2,4</sup>				S-P-F <sup>2,4</sup>				
			L	SH	T	Wood to Wood		Steel to Wood				Wood to Wood	Steel to Wood			
								(DF-L to DF-L)	12 Gauge	10 Gauge	7 Gauge		3 Gauge	(S-P-F to S-P-F)	12 Gauge	10 Gauge
WS15	SDS25112	1/4" x 1-1/2"	1-1/2"	1/4"	1-1/4"	Zinc	---	251	248	244	243	---	217	214	211	211
<b>WS15-GC</b>	---	1/4" x 1-1/2"	1-1/2"	1/4"	1-1/4"	GC	---	251	248	244	243	---	217	214	211	211
WS17	SDS25134	1/4" x 1-3/4"	1-3/4"	3/8"	1-3/8"	Zinc	---	296	293	290	292	---	255	253	251	253
WS2	SDS25200	1/4" x 2"	2"	1/4"	1-3/4"	Zinc	---	304	306	313	327	---	262	264	271	284
WS25	SDS25212	1/4" x 2-1/2"	2-1/2"	1/4"	2-1/4"	Zinc	177	304	306	313	327	137	262	264	271	284
WS3	SDS25300	1/4" x 3"	3"	3/4"	2-1/4"	Zinc	229	304	306	313	327	177	262	264	271	284
WS35	SDS25312	1/4" x 3-1/2"	3-1/2"	3/4"	2-3/4"	Zinc	229	304	306	313	327	177	262	264	271	284
WS4	---	1/4" x 4"	4"	1"	3"	Zinc	229	304	306	313	327	177	262	264	271	284
WS45	SDS25412	1/4" x 4-1/2"	4-1/2"	1-1/4"	3-1/4"	Zinc	272	304	306	313	327	216	262	264	271	284
WS6	SDS25600	1/4" x 6"	6"	1-3/4"	4-1/4"	Zinc	272	304	306	313	327	216	262	264	271	284

1) Zinc = Yellow zinc dichromate; GC = Gold Coat.  
 2) Allowable loads are based on the 1997 NDS®. Light Gauge or 3 Gauge loads given assume use with metal side plates, Fes = 45 ksi.  
 3) Wood-to-wood loads are based on 1-1/2" thick wood side members.  
 4) Loads are for 100% duration of load factors, and may be increased for other duration factors in accordance with the NDS.  
 5) Loads are for shear applications when used as described in this catalog. Please contact USP for applications and installations involving tension forces.  
**New products or updated product information are designated in red.**

USP Stock No.	Triple Zinc (TZ)	Hot-Dip Galvanized (HDG)	Stainless Steel (SS)	Gold Coat (GC)
<b>Fasteners / Anchors</b>				
AB1212-HDG		X		
AB1218-HDG		X		
AB126-HDG		X		
AB128-HDG		X		
AB5817-HDG		X		
BP1		X		
BP12		X		
BP34		X		
BP58		X		
BP582		X		
BP583		X		
BP78		X		
HBPS12		X		
HBPS34		X		
LBP12-TZ	X			
LBP34-TZ	X			
LBP58-TZ	X			
LBPS12-TZ	X			
LBPS58-TZ	X			
N8-GC				X
N8C-GC				X
N10-GC				X
N10C-GC				X
N16C-GC				X
NA11		X	X	
NA16D		X		
NA20D		X		
NA21		X		
NA25		X		
NA250		X		
NA9D		X		
STB16		X		
STB20		X		
STB24		X		
STB28		X		
STB34		X		
STB36		X		
STBL16		X		
STBL20		X		
STBL24		X		
STBL28		X		
STBL34		X		
WS15-GC				X
<b>Holdowns / Foundation Anchors</b>				
FA3	X			
HPA35		X		
PA18	X			
PA23	X			
PA28	X			
PA35	X			
ST1-TZ	X			
ST2-TZ	X			
TA51	X			
TA71	X			
TDL5	X			
TDL10	X			
TDX2	X	X		
TDX6		X		
TDX8		X		
<b>Embedded Truss Anchors</b>				
H1A20	X			
HTA24	X			
TA20	X			
TA24	X			

USP Stock No.	Triple Zinc (TZ)	Hot-Dip Galvanized (HDG)	Stainless Steel (SS)	Gold Coat (GC)
<b>Stud Plate Ties</b>				
RSPT4		X		
RSPT6		X		
RSPT6-2		X		
SPT4		X		
SPT6		X		
SPT22		X		
SPT24		X		
SPTH4		X		
SPTH6		X		
<b>Column / Post Bases</b>				
CBS44		X		
CBS66		X		
CBSQ44-TZ	X			
CBSQ46-TZ	X			
CBSQ66-TZ	X			
D44	X			
D46	X			
D66	X			
EBG44	X			
EPB4408		X		
KCB44		X		
KCB46		X		
KCB48		X		
KCB66		X		
KCB68		X		
KCB88		X		
KCB1010		X		
KCB1212		X		
PA44	X			
PA44E	X			X
PA46	X			
PA46E	X			X
PA66	X			
PA66E	X			X
PAU44	X			
PAU46	X			
PAU66	X			
PAU88	X			
WAS44	X			
WAS46	X			
WAS66	X			
WE44	X			
WE46	X			
WE66	X			
<b>Column / Post Caps</b>				
C44	X			
C46	X			
C66	X			
EPCM4416	X			
EPCM4616	X			
KCC44		X		
KCC46		X		
KCC64		X		
KCC66		X		
KECC44		X		
KECC46		X		
KECC64		X		
KECC66		X		
PB44-6	X			X
PB66-6	X			X
PBC44-TZ	X			
PBC66-TZ	X			

USP Stock No.	Triple Zinc (TZ)	Hot-Dip Galvanized (HDG)	Stainless Steel (SS)	Gold Coat (GC)
<b>Column / Post Caps</b>				
PBES44		X		
PBES66		X		
PBS44		X		
PBS66		X		
PCM44		X		
PCM4416		X		
PCM46		X		
PCM4616		X		
PCM66		X		
PCM6616		X		
<b>Joist Hangers</b>				
HUS26		X		
HUS28		X		
HUS28-2IF		X		
HUS210		X		
HUS210-2IF		X		
JUS24			X	X
JUS26			X	X
JUS26-2			X	X
JUS28			X	
JUS28-2			X	
JUS28-3			X	
JUS210			X	X
JUS210-2			X	X
JUS210-3			X	
JUS44			X	
JUS46			X	
JUS48			X	
JUS410			X	
JUS414			X	
LSSH15-TZ			X	
LSSH210			X	
LSSH31			X	
SKH26R/L				X
SKH28R/L				X
SKH210R/L				X
TMU26			X	
<b>Hurricane / Seismic Anchors</b>				
HHCP2		X		
LFTA6		X		
RT3A		X		
RT4		X		X
RT5		X		X
RT7		X		X
RT7A		X		X
RT10		X		X
RT15		X		X
RT16		X		X
RT16-2		X		
RT20		X		
<b>Truss Hangers</b>				
HJH28L/R		X		
MSH418		X		
MSH422		X		
THD26		X		
THD26-2		X		
THD210-2		X		

USP Stock No.	Triple Zinc (TZ)	Hot-Dip Galvanized (HDG)	Stainless Steel (SS)	Gold Coat (GC)
<b>Framing Plates &amp; Angles</b>				
A3		X		
AC5		X		
AC7		X		X
AC9		X		X
JA1		X		
MP3		X		
MP34		X		X
MP4F		X		
MP5		X		
MP7		X		X
MP9		X		X
MPA1		X		X
MPA1F		X		X
<b>Straps</b>				
KRPS18		X		
KRPS22		X		
L6		X		X
LSTA24				X
MSTA9		X		
MSTA12		X		X
MSTA15		X		X
MSTA18		X		X
MSTA21		X		
MSTA24		X		
MSTA30		X		
MSTA36		X		
PS218-HDG			X	
PS418-HDG			X	
PS720-HDG			X	
RS150		X		
RT24F		X		
T6		X		X
<b>Twist Straps</b>				
LTW12		X		X
LTW18		X		X
LTW20				X
MTW12		X		
MTW16		X		
MTW20		X		
MTW30		X		
RT16T		X		
RT24T		X		
<b>Miscellaneous</b>				
ANJ44S		X		
DC50-TZ		X		
CSH-TZ		X		
ERB24-TZ		X		
FB14-TZ		X		
FB16-TZ		X		
FB23-TZ		X		
FB240-TZ		X		
FRB24-TZ		X		
ICPL58		X		
ICPL516-TZ		X		
PRT2-TZ		X		
SCA9-TZ		X		X
SCA10-TZ		X		X
SDJT14-TZ		X		
SDPT5-TZ		X		
SDPT7-TZ		X		