

See Specialty Options Chart for each hanger series for load reductions and hanger maximum range of skew, slope, etc.

Skewed Hanger:

- Joist nails may be located on obtuse side to ensure proper nailing.
- Specify skew angle, type (A or B), and direction when ordering.

Sloped Seat Hanger:

- Additional nail holes may be added to joist flanges.
- Specify slope angle, direction, and joist height when ordering.

Sloped/Skewed Hanger:

- See nailing notes for both skewed and sloped hangers.
- Specify skew and slope angles as well as skew/slope directions, and skew type (A or B) when ordering.
- Similar to face mount skewed/sloped hanger, refer to illustration on page 195: Typical HD hanger sloped down, skewed left shown.
- Specify if hanger is to be high side flush, low side flush, or center flush.

Sloped/Skewed/Sloped Top Flange Hanger:

- See nailing notes for both skewed and sloped hangers.
- Specify skew, slope, and top flange slope angles as well as skew/slope and top flange slope directions when ordering.
- Skewed/sloped/top flange sloped hangers can be made galvanized or painted.

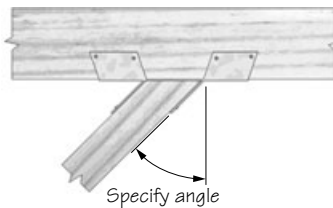

Typical BPH hanger skewed, left shown Type A (bevel cut required)

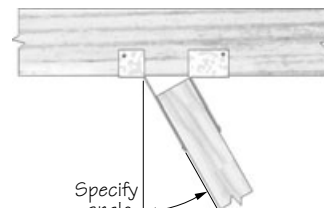

Typical BPH hanger skewed, right shown Type B

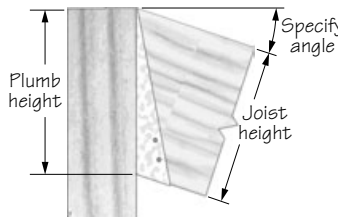

Typical BPH hanger sloped seat, down shown

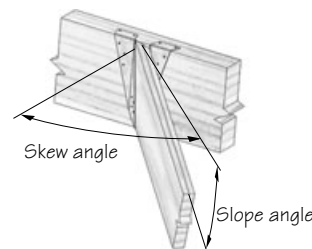

Typical BPH hanger sloped down, skewed right, low side flush shown

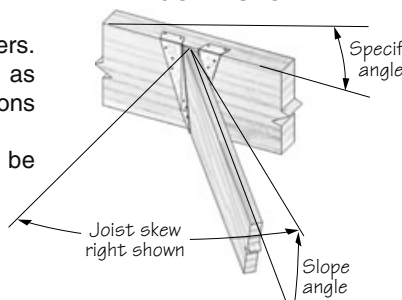

Typical BPH hanger skewed right, sloped down, top flange sloped

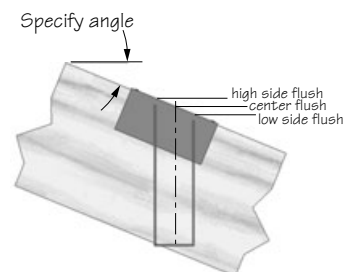

Typical HLBH hanger sloped top flange right shown

© Copyright 2010 USP Structural Connectors®

SOLID TOP FLANGE HANGER SPECIALTY DETAILS

See Specialty Options Chart for each hanger series for load reductions and hanger maximum range of skew, slope, etc.

Skewed Hanger:

- Joist nails may be located on obtuse side to ensure proper nailing.
- Specify skew angle, type (A or B), and direction when ordering.

Sloped Seat Hanger:

- Additional nail holes may be added to joist flanges.
- Specify slope angle, direction, and joist height when ordering.

Sloped/Skewed Hanger:

- See nailing notes for both skewed and sloped hangers.
- Specify skew and slope angles as well as skew/slope directions, and skew type (A or B) when ordering.
- Specify if hanger is to be high side flush, low side flush, or center flush.

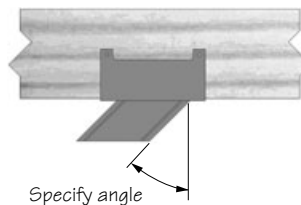

Typical PHXU hanger skewed, left shown Type A (bevel cut required)

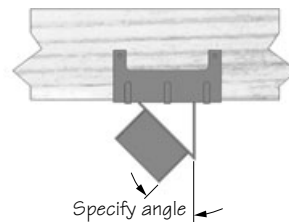

Typical PHXU hanger skewed, left shown Type B

continued on next page