

The WS Wood Screw is a self-drilling screw used for numerous framing applications. This screw features a reverse locking serration on the bottom of the screw head to help prevent over tightening against a steel plate. The USP head stamp identifies screws for easy inspection.

Screw shear capacities are based on a diameter of 0.242" when the shear plane is on the screw shank (SH) and 0.185" when the shear plane is on the knurl or threads (T). USP WS Wood Screws have a bending yield strength of 217,000 psi. For conditions not charted here, screw loads may be calculated as shown in the NDS® and increased for duration of load.

Materials: 1/4" diameter Grade 5 steel
Finish: See chart
Codes: ESR-2761, FL13170

Installation:

- Screws are self-drilling.
- Install using a low speed clutch drill with 3/8" hex head driver. The washer head should be flat to the surface and the serrations will oppose turning and release the clutch. Do not over-tighten the screws.
- Installing the screw at an angle may introduce additional bending and tension forces into the fastener if the screw head is not flat on the bearing surface. Care should be given to ensure the fastener is installed perpendicular to the plane of the side plate.

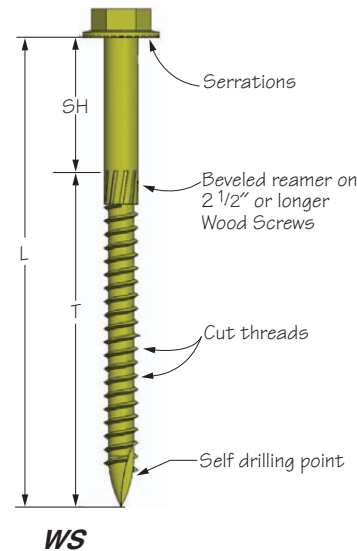

© Copyright 2011 USP Structural Connectors®

For Attaching Multi-Ply Wood Trusses or LVL or PSL members, or floor trusses, see pages 19-21.

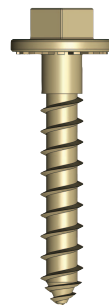

**AVAILABLE IN
GOLD
COAT**

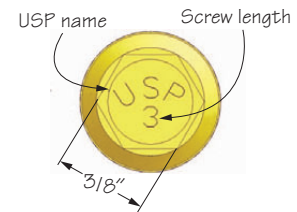

USP Stock No.	Ref. No.	Description	Dimensions				DF-L / SP ^{2,4,5}					S-P-F ^{2,4,5}					Code Ref.		
			L	SH	T	Finish ¹	Shear (100%)				Withdrawal Capacity	Shear (100%)				Withdrawal Capacity			
							Wood to Wood ³	Steel to Wood ⁶				Wood to Wood ³	Steel to Wood ⁶						
								14 Ga	10 Ga	7 Ga			3 Ga	100%	14 Ga			10 Ga	7 Ga
WS15	SDS25112	1/4" x 1-1/2"	1/2	1/4	1-1/4	Zinc	--	230	261	259	266	164	--	188	211	190	217	103	12, F29
WS15-GC	--	--	--	--	GC	--	--	--	--	--	--	160	--	--	--	--	117		
WS2	SDS25200	1/4" x 2"	2	1/4	1-3/4	Zinc	--	306	307	289	316	160	--	215	244	249	248	117	
WS25	SDS25212	1/4" x 2-1/2"	2-1/2	1/4	2-1/4	Zinc	193	362	352	338	369	199	141	256	292	286	294	141	
WS3	SDS25300	1/4" x 3"	3	3/4	2-1/4	Zinc	227	418	396	387	457	199	164	297	340	322	365	141	
WS35	SDS25312	1/4" x 3-1/2"	3-1/2	3/4	2-3/4	Zinc	233	451	460	454	481	208	181	338	380	356	370	154	
WS45	SDS25412	1/4" x 4-1/2"	4-1/2	1-1/4	3-1/4	Zinc	233	516	588	589	531	214	181	421	460	425	379	163	
WS6	SDS25600	1/4" x 6"	6	1-3/4	4-1/4	Zinc	233	516	588	589	531	214	181	421	460	425	379	163	

1) Zinc = Yellow Zinc Dichromate; GC = Gold Coat.
 2) Allowable shear loads assume a side plate tensile strength of 45 ksi for 14 gauge and 10 gauge, 52 ksi for 7 gauge and 58 ksi for 3 gauge.
 3) Shear loads for wood-to-wood connections assume a side member thickness of 1-1/2".
 4) Loads are for 100% duration of load factors, and may be increased for other duration factors in accordance with the NDS.
 5) Loads are for shear applications when used as described in this catalog. Please contact USP for applications and installations involving tension forces.
 6) Withdrawal loads for steel-to-wood connections assume a side plate thickness of 1/4" or less.
 New products or updated product information are designated in **bold font**.