

The SNP3 Skewed Nail Plate is designed and tested for connecting square cut corner jack trusses at skewers from 45° to 90°.

Materials: 16 gauge
Finish: G90 galvanizing
Codes: ESR-2104, FL820,
 L.A. City RR 25745

Installation:

- Install specified fasteners from bend line out from each end. Not all nail holes will be filled.
- Attach to the supported truss on the acute angle side so the SNP3 runs behind the end of the jack.
- Set jack truss against supporting truss and nail on exposed flange.
- **Bend angle only once.**
- 8d common nails may be substituted for 8d x 1 1/2" nails with no reduction in load.

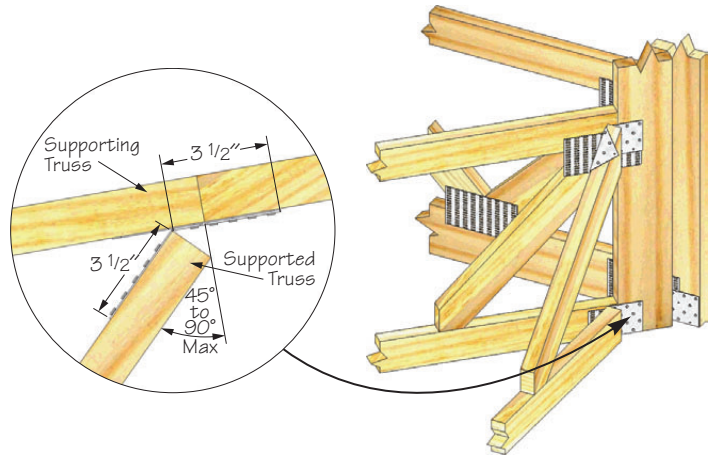

Typical SNP3 installation

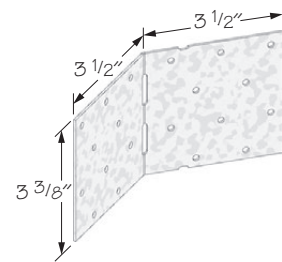

SNP3

Plated Truss

© Copyright 2011 USP Structural Connectors®

USP Stock No.	Ref. No.	Steel Gauge	Fastener Schedule ²				Wood Species	Allowable Loads (Lbs.) ¹				Code Ref.
			Supporting Member		Supported Member			100%	115%	125%	Upift 160%	
			Qty	Type	Qty	Type						
SNP3	TJC37	16	6	8d x 1-1/2	6	8d x 1-1/2	DF-L	530	530	530	530	8, F14, R9
							SP	530	530	530	530	
							S-P-F	445	445	445	445	

1) Allowable loads have been increased 60% for wind or seismic loads; no further increase shall be permitted.
 2) 8d x 1-1/2" nails are 11 gauge (0.131" diameter) by 1-1/2" long.