

THD – Medium capacity hanger for LVL, LSL, and PSL beams.

THDH – Heavy capacity hanger for LVL, LSL, and PSL beams.

Materials: See EWP Face Mount Hangers charts, pages 121-122.

Finish: G90 galvanizing

Options: Rough/ Full sizes available for THD series. THD hangers with widths greater than 3" can have one flange inverted with no load reduction. Specify left (*L*) or (*R*) flange. See Specialty Options chart.

Codes: ESR-1781, ESR-1881, FL821, FL9835, **FL13285**

Dade County FL 06-0921.05 , L.A. City RR 25779, **L.A. City RR 25843**

Installation:

- Use all specified fasteners. See Product Notes, page 11.
- THD – Drive bend line nails into header at 45° to achieve listed loads.
- THDH – Drive joist nails into header at 30° to 45° to achieve listed loads.

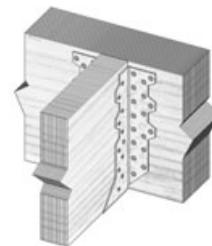

Typical THD installation

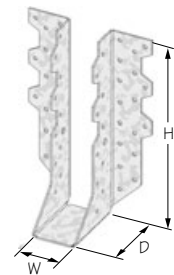

THD single

Some model designs may vary from illustration shown

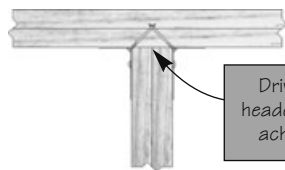

Drive joist nails into header at 30° to 45° to achieve listed loads.

Typical THDH double shear installation

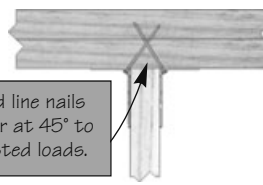

Drive bend line nails into header at 45° to achieve listed loads.

Typical THD bend line nail installation

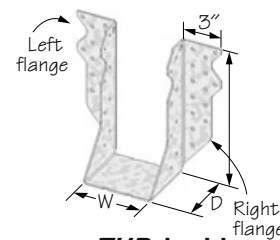

THD double or larger

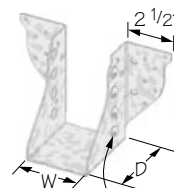

Raised dimple allows 30° to 45° nailing

THDH26-2

Specialty Options Chart – refer to Specialty Options pages 194 to 195 for additional details.

| Option | USP Series | Skewed ^{1,3,4} | Sloped Seat ^{2,3,4} | Sloped / Skewed ^{1,2,3,4} | Inverted Flange |
|-----------------|------------|---|--|--|---|
| Range | THD | 1° to 45° | 1° to 45° | See Sloped Seat and Skewed | Not available in widths less than 3". Widths greater can have one flange inverted. |
| | THDH | 1° to 45° | 1° to 45° | See Sloped Seat and Skewed | N/A |
| Allowable Loads | THD | 85% of table load | 65% of table load | 65% of table load | 100% of table load. 65% of table load when nailing into the support members end grain. |
| | THDH | 85% of table load. 50% of table uplift load. | 52% of table load | 52% of table load. 50% of table uplift load. | N/A |
| Ordering | THD | Add SK, angle required, and right (<i>R</i>) or left (<i>L</i>), to product number. | Add SL, slope required, and up (<i>U</i>) or down (<i>D</i>), to product number. | See Sloped Seat and Skewed Example: THDH410-SK45RSL30D | Add 1/ <i>I</i> , one flange, right (<i>R</i>) and left (<i>L</i>), Example: THD4101IFR |
| | THDH | Example: THDH410-SK45R | Example: THDH410-SL30D | | N/A |

1) Skewed hangers with skews greater than 15° may have all joist nailing on outside flange. All skewed THDH hangers have nails on one side only.
 2) Sloped or sloped / skewed hangers with slopes greater than 15° may have additional joist nails.
 3) THDH models - All sloped, skewed, or combinations require bevel cut on joist in all applications.
 4) THD models - All sloped, skewed, or combinations require bevel cut or square cut on joist in all applications.

EWP FACE MOUNT HANGERS – SCL CHARTS



EWP Hangers

© Copyright 2010 USP Structural Connectors®

| Joist Size | USP Stock No. | Ref. No. | Web Stiffener Req'd. | Steel Gauge | Dimensions | | | Fastener Schedule ⁴ | | | | Allowable Loads (Lbs.) | | | | | | | | Code Ref. |
|-------------------------|---------------|---|----------------------|-------------|------------|----------|-------|--------------------------------|------|--------------------|-------------|------------------------|------|------|------|---------------------|------|------|------|----------------------|
| | | | | | W | H | D | Header ² | | Joist ¹ | | DF-L / SP Header | | | | S-P-F Header | | | | |
| | | | | | | | | Qty | Type | Qty | Type | 100% | 115% | 125% | 160% | Uplift ³ | 100% | 115% | 125% | |
| 1-3/4 x 7-1/4 | HD1770 | HU7 | x | 14 | 1-13/16 | 7-1/8 | 2 | 14 | 16d | 4 | 10d x 1-1/2 | 1975 | 2270 | 2335 | 730 | 1695 | 1945 | 1960 | 635 | 5, F30, R5 |
| 1-3/4 x 9-1/2 | HD17925 | HU9, MIU1.81/9 | x | 14 | 1-13/16 | 9-1/8 | 2 | 18 | 16d | 6 | 10d x 1-1/2 | 2540 | 2775 | 2775 | 1065 | 2080 | 2170 | 2230 | 895 | 6, F15, F18, D2, R13 |
| | HDQ1791F | HUCQ1.81/9-SDS | x | 14 | 1-13/16 | 9 | 3 | 8 | WS3 | 4 | WS15 | 3010 | 3380 | 3380 | 1050 | 2840 | 2840 | 2840 | 990 | 130 |
| | HUS179 | HUS1.81/10 | x | 16 | 1-13/16 | 9-1/8 | 3 | 30 | 16d | 10 | 16d | 5310 | 5510 | 5510 | 3205 | 4410 | 4630 | 4630 | 2690 | 6, F15, F18, D2, R13 |
| 1-3/4 x 11-1/4 - 11-7/8 | HD17112 | HU11, MIU1.81/11 | x | 14 | 1-13/16 | 11-3/8 | 2 | 22 | 16d | 6 | 10d x 1-1/2 | 2870 | 2975 | 3045 | 1065 | 2080 | 2170 | 2230 | 895 | 5, F30, R5 |
| | HDQ17112IF | HUCQ1.81/11-SDS | x | 14 | 1-13/16 | 11 | 3 | 10 | WS3 | 6 | WS15 | 3340 | 3340 | 3340 | 1575 | 2805 | 2805 | 2805 | 1325 | 130 |
| | HUS179 | HUS1.81/10 | x | 16 | 1-13/16 | 9-1/8 | 3 | 30 | 16d | 10 | 16d | 5310 | 5510 | 5510 | 3205 | 4410 | 4630 | 4630 | 2690 | 6, F15, F18, D2, R13 |
| 1-3/4 x 14 | HD1714 | HU14, MIU1.81/14, MIU1.81/16, MIU1.81/18, U14 | x | 14 | 1-13/16 | 13-5/16 | 2 | 26 | 16d | 8 | 10d x 1-1/2 | 3100 | 3235 | 3330 | 1065 | 2280 | 2400 | 2480 | 895 | 5, F30, R5 |
| | HDQ1714IF | -- | x | 14 | 1-13/16 | 13-3/8 | 3 | 12 | WS3 | 6 | WS15 | 3340 | 3340 | 3340 | 1580 | 2805 | 2805 | 2805 | 1325 | 130 |
| | HUS179 | HUS1.81/10 | x | 16 | 1-13/16 | 9-1/8 | 3 | 30 | 16d | 10 | 16d | 5310 | 5510 | 5510 | 3205 | 4410 | 4630 | 4630 | 2690 | 6, F15, F18, D2, R13 |
| 1-3/4 x 16 | HD1714 | HU14, MIU1.81/14, MIU1.81/16, MIU1.81/18, U14 | x | 14 | 1-13/16 | 13-5/16 | 2 | 26 | 16d | 8 | 10d x 1-1/2 | 3100 | 3235 | 3330 | 1065 | 2280 | 2400 | 2480 | 895 | 5, F30, R5 |
| | HDQ1714IF | -- | x | 14 | 1-13/16 | 13-3/8 | 3 | 12 | WS3 | 6 | WS15 | 3340 | 3340 | 3340 | 1580 | 2805 | 2805 | 2805 | 1325 | 130 |
| | HUS179 | HUS1.81/10 | x | 16 | 1-13/16 | 9-1/8 | 3 | 30 | 16d | 10 | 16d | 5310 | 5510 | 5510 | 3205 | 4410 | 4630 | 4630 | 2690 | 6, F15, F18, D2, R13 |
| 2-11/16 x 9-1/4 - 14 | HD27925 | HU2.75/10 | x | 14 | 2-3/4 | 8-5/8 | 2 | 18 | 16d | 6 | 10d x 1-1/2 | 2540 | 2775 | 2775 | 1065 | 2180 | 2330 | 2330 | 895 | 5, F30, R5 |
| | THDH27925 | HGUS2.75/10 | x | 12 | 2-3/4 | 9-1/8 | 4 | 46 | 16d | 12 | 16d | 8260 | 8260 | 8260 | 3490 | 6935 | 6935 | 6935 | 2930 | 6, F15, F18, D2, R13 |
| 2-11/16 x 11-1/4 - 16 | HD27112 | HU2.75/12 | x | 14 | 2-3/4 | 10-7/8 | 2 | 22 | 16d | 6 | 10d x 1-1/2 | 3100 | 3565 | 3610 | 1065 | 2660 | 2965 | 3025 | 895 | 5, F30, R5 |
| | THDH27112 | HGUS2.75/12 | x | 12 | 2-3/4 | 10-7/8 | 4 | 56 | 16d | 14 | 16d | 9845 | 9845 | 9845 | 5225 | 7655 | 8135 | 8270 | 4390 | 6, F15, R13 |
| 2-11/16 x 14 - 16 | HD2714 | HU2.75/14 | x | 14 | 2-3/4 | 12-7/8 | 2 | 26 | 16d | 8 | 10d x 1-1/2 | 3610 | 3610 | 3610 | 1065 | 3030 | 3030 | 3030 | 895 | 5, F30, R5 |
| | THDH2714 | HGUS2.75/14 | x | 12 | 2-3/4 | 12-1/4 | 4 | 66 | 16d | 16 | 16d | 9845 | 9845 | 9845 | 6810 | 8110 | 8270 | 8270 | 5835 | 6, F15, R13 |
| 3-1/2 x 9-1/4 - 14 | HD410 | HU410, MIU3.56/9 | x | 14 | 3-9/16 | 8-13/16 | 2-1/2 | 18 | 16d | 10 | 10d | 2540 | 2920 | 3175 | 1905 | 2180 | 2505 | 2725 | 1650 | 5, F30, R5 |
| | HDQ410IF | HUCQ410-SDS | x | 14 | 3-9/16 | 9 | 3 | 12 | WS3 | 6 | WS3 | 4510 | 5190 | 5590 | 2975 | 4430 | 4695 | 4695 | 2500 | 130 |
| | THD410 | HHUS410 | x | 14 | 3-5/8 | 9-1/16 | 3 | 38 | 16d | 20 | 10d | 5360 | 6160 | 6700 | 3810 | 4600 | 5290 | 5750 | 3235 | 5, F18, F30, D2, R5 |
| | THDH410 | HGUS410 | x | 12 | 3-9/16 | 9-1/8 | 4 | 46 | 16d | 12 | 16d | 8260 | 9010 | 9010 | 3970 | 7120 | 7570 | 7570 | 3335 | 6, F18, F15, D2, R13 |
| 3-1/2 x 11-1/4 - 16 | HD412 | HU412, MIU3.56/11 | x | 14 | 3-9/16 | 10-13/16 | 2-1/2 | 22 | 16d | 10 | 10d | 3100 | 3565 | 3880 | 1905 | 2660 | 3060 | 3330 | 1650 | 5, F30, R5 |
| | HDQ412IF | HUCQ412-SDS | x | 14 | 3-9/16 | 11 | 3 | 14 | WS3 | 6 | WS3 | 5265 | 5590 | 5590 | 2975 | 4695 | 4695 | 4695 | 2500 | 130 |
| | THD412 | -- | x | 14 | 3-5/8 | 11 | 3 | 48 | 16d | 20 | 10d | 6770 | 7045 | 7045 | 3810 | 5810 | 5920 | 5920 | 3235 | 5, F18, F30, D2, R5 |
| | THDH412 | HGUS412 | x | 12 | 3-9/16 | 10-1/2 | 4 | 56 | 16d | 14 | 16d | 9845 | 9845 | 9845 | 5225 | 8270 | 8270 | 8270 | 4390 | 6, F15, R13 |

1) 10d x 1-1/2 nails are 9 gauge (0.148" diameter) by 1-1/2" long.
 2) Uplift loads have been increased 60% for wind or seismic loads; no further increase shall be permitted.
 3) Minimum nail penetration shall be 1-1/2" for 10d nails and 1-5/8" for 16d nails.
 4) WS3 Wood Screws are 1/4" x 3" and are included with HDQ hangers.

Load tables address hanger/header/fastener limitations only. Joist limitations must be determined for each installation.
 New products or updated product information are designated in bold font.

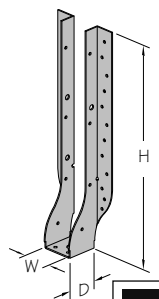

continued on next page

| Joist Size | USP Stock No. | Ref. No. | Web Stiffener Req'd. | Steel Gauge | Dimensions | | | Fastener Schedule ⁴ | | | | Allowable Loads (Lbs.) | | | | | | | | Code Ref. |
|------------------------|---------------|--------------------------|----------------------|-------------|------------|----------|-------|--------------------------------|------|--------------------|------|------------------------|-------|-------|------|--------------|------|------|------|----------------------|
| | | | | | W | H | D | Header ² | | Joist ¹ | | DF-L / SP Header | | | | S-P-F Header | | | | |
| | | | | | | | | Qty | Type | Qty | Type | 100% | 115% | 125% | 160% | 100% | 115% | 125% | 160% | |
| 3-1/2 x 14 - 20 | HD414 | HU414, MIU3.56/14 | x | 14 | 3-9/16 | 12-13/16 | 2-1/2 | 24 | 16d | 10 | 10d | 3385 | 3890 | 4230 | 1905 | 2905 | 3340 | 3630 | 1650 | 5, F30, R5 |
| | THD414 | -- | x | 14 | 3-5/8 | 12-7/8 | 3 | 58 | 16d | 20 | 10d | 7045 | 7045 | 7045 | 3810 | 5920 | 5920 | 5920 | 3235 | 5, F30, R5 |
| | THDH414 | HGUS414 | x | 12 | 3-9/16 | 13-1/16 | 4 | 66 | 16d | 16 | 16d | 9845 | 9845 | 9845 | 6810 | 8270 | 8270 | 8270 | 5835 | 6, F15, R13 |
| 3-1/2 x 16 - 22 | HD416 | HU416, MIU3.56/16 | x | 14 | 3-9/16 | 14-13/16 | 2-1/2 | 26 | 16d | 12 | 10d | 3665 | 4215 | 4570 | 2285 | 3145 | 3620 | 3840 | 1980 | 5, F30, R5 |
| 3-1/2 x 18 - 26 | HD418 | MIU3.56/18, MIU3.56/20 | x | 14 | 3-9/16 | 16-1/2 | 2-1/2 | 28 | 16d | 8 | 10d | 3950 | 4540 | 4570 | 1425 | 3390 | 3840 | 3840 | 1195 | |
| 5-1/4 x 9-1/4 - 11-7/8 | HD5210 | HU5.31/9 | x | 14 | 5-3/8 | 7-7/8 | 2-1/2 | 18 | 16d | 10 | 10d | 2540 | 2920 | 3175 | 1905 | 2180 | 2505 | 2725 | 1650 | 5, F18, F30, D2, R5 |
| | HDQ5210IF | HUCQ5.25/9-SDS | x | 14 | 5-1/4 | 9 | 3 | 12 | WS3 | 6 | WS3 | 4510 | 5190 | 5590 | 2975 | 4430 | 4695 | 4695 | 2500 | |
| | THD610 | HHUS5.50/10 | x | 12 | 5-1/2 | 9 | 3 | 38 | 16d | 20 | 10d | 5660 | 6510 | 7080 | 3410 | 4900 | 5635 | 6130 | 2865 | |
| | THDH610 | HGUS5.25/10, HGUS5.50/10 | x | 12 | 5-1/2 | 9 | 4 | 46 | 16d | 16 | 16d | 8725 | 9855 | 9855 | 4565 | 7520 | 8275 | 8275 | 3835 | 6, F15, R13 |
| 5-1/4 x 11-1/4 - 16 | HD5212 | HU5.31/11 | x | 14 | 5-3/8 | 9-7/8 | 2-1/2 | 22 | 16d | 10 | 10d | 3100 | 3565 | 3880 | 1905 | 2660 | 3060 | 3330 | 1650 | 5, F30, R5 |
| | HDQ5212IF | HUCQ5.25/11-SDS | x | 14 | 5-1/4 | 11 | 3 | 14 | WS3 | 6 | WS3 | 5265 | 5590 | 5590 | 2975 | 4695 | 4695 | 4695 | 2500 | 130 |
| | THD612 | -- | x | 12 | 5-1/2 | 11 | 3 | 48 | 16d | 20 | 10d | 7150 | 8225 | 8415 | 4065 | 6190 | 7070 | 7070 | 3520 | 5, F18, F30, D2, R5 |
| | THDH612 | HGUS5.25/12, HGUS5.50/12 | x | 12 | 5-1/2 | 11 | 4 | 56 | 16d | 20 | 16d | 9935 | 9935 | 9935 | 5180 | 8345 | 8345 | 8345 | 4355 | 6, F15, R13 |
| 5-1/4 x 14 - 20 | HD5214 | HU5.31/14 | x | 14 | 5-3/8 | 11-7/8 | 2-1/2 | 24 | 16d | 10 | 10d | 3385 | 3890 | 4230 | 1905 | 2905 | 3340 | 3630 | 1650 | 5, F30, R5 |
| | THD614 | -- | x | 12 | 5-1/2 | 12-7/8 | 3 | 58 | 16d | 20 | 10d | 8415 | 8415 | 8415 | 4065 | 7070 | 7070 | 7070 | 3520 | 5, F30, R5 |
| | THDH614 | HGUS5.50/14 | x | 12 | 5-1/2 | 13 | 4 | 66 | 16d | 22 | 16d | 11645 | 11645 | 11645 | 5795 | 9780 | 9780 | 9780 | 4865 | 6, F15, R13 |
| 5-1/4 x 16 - 22 | HD5216 | HU5.31/16 | x | 14 | 5-3/8 | 13-7/8 | 2-1/2 | 30 | 16d | 12 | 10d | 4230 | 4570 | 4570 | 2285 | 3630 | 3840 | 3840 | 1980 | 5, F30, R5 |
| 6-3/4 x 9 - 14-1/2 | THDH6710 | HGUS210-4, HGUS6.88/10 | x | 12 | 6-7/8 | 8-13/16 | 4 | 46 | 16d | 12 | 16d | 8260 | 8260 | 8260 | 3490 | 6935 | 6935 | 6935 | 2930 | 6, F15, F18, D2, R13 |
| 6-3/4 x 11 - 18 | THDH6712 | HGUS212-4, HGUS6.88/12 | x | 12 | 6-7/8 | 10-13/16 | 4 | 56 | 16d | 14 | 16d | 9845 | 9845 | 9845 | 5225 | 8270 | 8270 | 8270 | 4390 | 6, F15, R13 |
| 6-3/4 x 13 - 20-1/2 | THDH6714 | HGUS214-4, HGUS6.88/14 | x | 12 | 6-7/8 | 12-13/16 | 4 | 66 | 16d | 16 | 16d | 9845 | 9845 | 9845 | 6810 | 8270 | 8270 | 8270 | 5835 | |
| 7 x 9-1/4 - 14 | HD7100 | HU410-2 | x | 14 | 7-1/8 | 9 | 2-1/2 | 12 | 16d | 6 | 10d | 1690 | 1945 | 2115 | 1140 | 1450 | 1670 | 1815 | 990 | 5, F30, R5 |
| | THD7210 | HHUS7.25/10 | x | 12 | 7-1/4 | 9 | 3 | 38 | 16d | 20 | 10d | 5660 | 6510 | 7080 | 3410 | 4900 | 5635 | 6130 | 2865 | 5, F18, F30, D2, R5 |
| | THDH7210 | HGUS7.25/10 | x | 12 | 7-1/4 | 9 | 4 | 46 | 16d | 12 | 16d | 8260 | 9010 | 9010 | 3970 | 7120 | 7570 | 7570 | 3335 | 6, F15, F18, D2, R13 |
| 7 x 11-1/4 - 16 | HD7120 | HU412-2 | x | 14 | 7-1/8 | 10-5/8 | 2-1/2 | 16 | 16d | 6 | 10d | 2255 | 2595 | 2820 | 1140 | 1935 | 2225 | 2420 | 990 | 5, F30, R5 |
| | THDH7212 | HGUS7.25/12 | x | 12 | 7-1/4 | 10-1/2 | 4 | 56 | 16d | 14 | 16d | 9845 | 9845 | 9845 | 5225 | 8270 | 8270 | 8270 | 4390 | 6, F15, R13 |
| 7 x 14 - 20 | HD7140 | HU414-2 | x | 14 | 7-1/8 | 13-1/8 | 2-1/2 | 20 | 16d | 8 | 10d | 2820 | 3245 | 3525 | 1525 | 2420 | 2785 | 3025 | 1320 | 5, F30, R5 |
| | THDH7214 | HGUS7.25/14 | x | 12 | 7-1/4 | 12-1/4 | 4 | 66 | 16d | 16 | 16d | 9845 | 9845 | 9845 | 6810 | 8270 | 8270 | 8270 | 5835 | 6, F15, R13 |
| 7 x 16 - 22 | HD7160 | -- | x | 14 | 7-1/8 | 15-5/8 | 2-1/2 | 24 | 16d | 8 | 10d | 3385 | 3890 | 4230 | 1525 | 2905 | 3340 | 3630 | 1320 | 5, F30, R5 |
| 7 x 18 - 26 | HD7180 | -- | x | 14 | 7-1/8 | 17-3/4 | 2-1/2 | 28 | 16d | 8 | 10d | 3950 | 4540 | 4570 | 1525 | 3390 | 3840 | 3840 | 1320 | |

1) 10d x 1-1/2 nails are 9 gauge (0.148" diameter) by 1-1/2" long.
 2) Uplift loads have been increased 60% for wind or seismic loads; no further increase shall be permitted.
 3) Minimum nail penetration shall be 1-1/2" for 10d nails and 1-5/8" for 16d nails.
 4) WS3 Wood Screws are 1/4" x 3" and are included with HDQ hangers.

Load tables address hanger/header/fastener limitations only. Joist limitations must be determined for each installation.

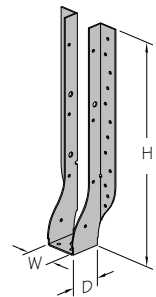

HEAVY-DUTY TRUSS HANGERS – THDH SERIES



Materials: 12 gauge
Finish: G90 galvanizing
Options: See Specialty Options Chart.
Codes: ESR-1881, FL821, FL9835,
 Dade County, FL 06-0921.05

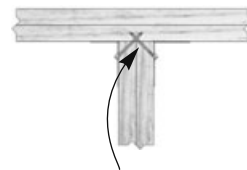

Drive joist nails into header at 30° to 45° to achieve listed loads.

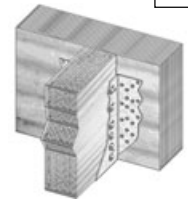

Typical THDH double shear installation

Installation:

- Use all specified fasteners. See Product Notes, page 11.
- Joist nails must be driven in at a 30° to 45° angle through the joist or truss into the header to achieve listed loads. **Standard length “double shear” nails must be used to achieve listed load values.**

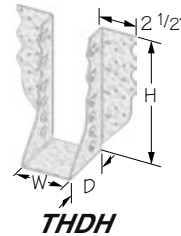

THDH

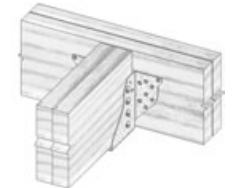

Typical THDH26-2 installation

See EWP applications pages 121-122.

| Joist / Truss Size | USP Stock No. | Ref. No. | Dimensions | | | Fastener Schedule ^{2,3} | | | | Allowable Loads (Lbs.) | | | | | | | | Code Ref. |
|-----------------------|---------------|-----------------------------|------------|----------|---|----------------------------------|------|-------|------|------------------------|-------|---------------------|------|-------|------|---------------------|------|----------------------|
| | | | W | H | D | Header | | Truss | | DF-L / SP | | | | S-P-F | | | | |
| | | | | | | Qty | Type | Qty | Type | Floor | Roof | Uplift ¹ | 160% | Floor | Roof | Uplift ¹ | 160% | |
| 2 x 6 - 8 | THDH26 | HGUS26 | 1-5/8 | 5-7/16 | 5 | 20 | 16d | 8 | 16d | 3915 | 4505 | 4895 | 2340 | 3370 | 3880 | 4200 | 1965 | 6, F15, F18, D2, R13 |
| 2 x 8 - 10 | THDH28 | HGUS28 | 1-5/8 | 7-3/16 | 5 | 36 | 16d | 12 | 16d | 6770 | 7395 | 7395 | 4370 | 5830 | 6210 | 6210 | 3670 | 6, F15, F18, D2, R13 |
| 2 x 10 - 12 | THDH210 | -- | 1-5/8 | 9-3/16 | 5 | 46 | 16d | 16 | 16d | 8725 | 9580 | 9600 | 5400 | 6835 | 7385 | 7750 | 4535 | 6, F15, R13 |
| 2-11/16 x 9-1/4 - 14 | THDH27925 | HGUS2.75/10 | 2-3/4 | 9-1/8 | 4 | 46 | 16d | 12 | 16d | 8260 | 8260 | 8260 | 3490 | 6935 | 6935 | 6935 | 2930 | 6, F15, F18, D2, R13 |
| 2-11/16 x 11-1/4 - 16 | THDH27112 | HGUS2.75/12 | 2-3/4 | 10-7/8 | 4 | 56 | 16d | 14 | 16d | 9845 | 9845 | 9845 | 5225 | 7655 | 8135 | 8270 | 4390 | 6, F15, R13 |
| 2-11/16 x 14 - 16 | THDH2714 | HGUS2.75/14 | 2-3/4 | 12-1/4 | 4 | 66 | 16d | 16 | 16d | 9845 | 9845 | 9845 | 6810 | 8110 | 8270 | 8270 | 5835 | 6, F15, R13 |
| 3-1/4 x 9-1/2 | THDH3210 | HGUS3.25/10 | 3-3/16 | 9-3/8 | 4 | 46 | 16d | 12 | 16d | 8260 | 8260 | 8260 | 3490 | 6935 | 6935 | 6935 | 2930 | 6, F15, F18, D2, R13 |
| 3-1/4 x 10-5/8 | THDH3212 | HGUS3.25/12 | 3-3/16 | 10-5/8 | 4 | 56 | 16d | 14 | 16d | 9845 | 9845 | 9845 | 5960 | 8270 | 8270 | 8270 | 5105 | 6, F15, R13 |
| (2) 2 x 6 - 8 | THDH26-2 | HGUS26-2 | 3-7/16 | 5-3/8 | 4 | 20 | 16d | 8 | 16d | 3915 | 4505 | 4795 | 2235 | 3370 | 3880 | 4030 | 1880 | 6, F18, F15, D2, R13 |
| (2) 2 x 8 - 10 | THDH28-2 | HGUS28-2 | 3-7/16 | 7-1/8 | 4 | 36 | 16d | 10 | 16d | 6535 | 7515 | 8025 | 2665 | 5635 | 6480 | 6740 | 2240 | 6, F15, R13 |
| (2) 2 x 10 - 12 | THDH210-2 | HGUS210-2 | 3-7/16 | 9-1/8 | 4 | 46 | 16d | 12 | 16d | 8260 | 8260 | 8260 | 3490 | 6935 | 6935 | 6935 | 2930 | 6, F18, F15, D2, R13 |
| 4 x 6 - 8 | THDH46 | HGUS46 | 3-9/16 | 5-3/8 | 4 | 20 | 16d | 8 | 16d | 3915 | 4505 | 4895 | 2605 | 3370 | 3880 | 4215 | 2190 | 6, F18, F15, D2, R13 |
| 4 x 8 - 10 | THDH48 | HGUS48 | 3-9/16 | 7-1/8 | 4 | 36 | 16d | 10 | 16d | 6535 | 7515 | 7835 | 3185 | 5635 | 6480 | 6580 | 2675 | 6, R13 |
| 4 x 10 - 12 | THDH410 | HGUS410 | 3-9/16 | 9-1/8 | 4 | 46 | 16d | 12 | 16d | 8260 | 9010 | 9010 | 3970 | 7120 | 7570 | 7570 | 3335 | 6, F18, F15, D2, R13 |
| 4 x 12 - 14 | THDH412 | HGUS412 | 3-9/16 | 10-1/2 | 4 | 56 | 16d | 14 | 16d | 9845 | 9845 | 9845 | 5225 | 8270 | 8270 | 8270 | 4390 | 6, F15, R13 |
| 4 x 14 - 16 | THDH414 | HGUS414 | 3-9/16 | 13-1/6 | 4 | 66 | 16d | 16 | 16d | 9845 | 9845 | 9845 | 6810 | 8270 | 8270 | 8270 | 5835 | 6, F15, R13 |
| (3) 2 x 6 - 8 | THDH26-3 | HGUS26-3 | 5-1/8 | 5-7/16 | 4 | 20 | 16d | 8 | 16d | 3915 | 4505 | 4795 | 2235 | 3370 | 3880 | 4030 | 1880 | 6, F18, F15, D2, R13 |
| (3) 2 x 8 - 10 | THDH28-3 | HGUS28-3 | 5-1/8 | 7-3/16 | 4 | 36 | 16d | 12 | 16d | 6770 | 7785 | 8025 | 2665 | 5830 | 6705 | 6740 | 2240 | 6, F18, F15, D2, R13 |
| (3) 2 x 10 - 12 | THDH210-3 | HGUS210-3 | 5-1/8 | 9-3/16 | 4 | 46 | 16d | 16 | 16d | 8725 | 9855 | 9855 | 4565 | 7520 | 8275 | 8275 | 3835 | 6, F15, F18, R13 |
| (3) 2 x 12 - 14 | THDH212-3 | HGUS212-3 | 5-1/8 | 11-3/16 | 4 | 56 | 16d | 20 | 16d | 9935 | 9935 | 9935 | 5180 | 8345 | 8345 | 8345 | 4355 | 6, F15, R13 |
| (3) 2 x 14 - 16 | THDH214-3 | HGUS214-3 | 5-1/8 | 13-3/16 | 4 | 66 | 16d | 22 | 16d | 11645 | 11645 | 11645 | 5795 | 9780 | 9780 | 9780 | 4865 | 6, F15, R13 |
| 6 x 10 - 12 | THDH610 | HGUS5.25/10, HGUS5.50/10 | 5-1/2 | 9 | 4 | 46 | 16d | 16 | 16d | 8725 | 9855 | 9855 | 4565 | 7520 | 8275 | 8275 | 3835 | 6, R13 |
| 6 x 12 - 14 | THDH612 | HGUS5.25/12, HGUS5.50/12 | 5-1/2 | 11 | 4 | 56 | 16d | 20 | 16d | 9935 | 9935 | 9935 | 5180 | 8345 | 8345 | 8345 | 4355 | 6, R13 |
| 6 x 14 - 16 | THDH614 | HGUS5.50/14 | 5-1/2 | 13 | 4 | 66 | 16d | 22 | 16d | 11645 | 11645 | 11645 | 5795 | 9780 | 9780 | 9780 | 4865 | 6, R13 |
| 6-3/4 x 9 - 14-1/2 | THDH6710 | HGUS210-4, HGUS6.88/10 | 6-7/8 | 8-13/16 | 4 | 46 | 16d | 12 | 16d | 8260 | 8260 | 8260 | 3490 | 6935 | 6935 | 6935 | 2930 | 6, F18, D2, R13 |
| 6-3/4 x 11 - 18 | THDH6712 | HGUS212-4, HGUS6.88/12 | 6-7/8 | 10-13/16 | 4 | 56 | 16d | 14 | 16d | 9845 | 9845 | 9845 | 5225 | 8270 | 8270 | 8270 | 4390 | 6, R13 |
| 6-3/4 x 13 - 20-1/2 | THDH6714 | HGUS214-4, HGUS6.88/14 | 6-7/8 | 12-13/16 | 4 | 66 | 16d | 16 | 16d | 9845 | 9845 | 9845 | 6810 | 8270 | 8270 | 8270 | 5835 | 6, R13 |
| 7-1/4 x 9-1/4 - 14 | THDH7210 | HGUS7.25/10 | 7-1/4 | 9 | 4 | 46 | 16d | 12 | 16d | 8260 | 9010 | 9010 | 3970 | 7120 | 7570 | 7570 | 3335 | 6, F18, D2, R13 |
| 7-1/4 x 11-1/4 - 16 | THDH7212 | HGUS7.25/12 | 7-1/4 | 10-1/2 | 4 | 56 | 16d | 14 | 16d | 9845 | 9845 | 9845 | 5225 | 8270 | 8270 | 8270 | 4390 | 6, R13 |
| 7-1/4 x 14 - 18 | THDH7214 | HGUS7.25/14 | 7-1/4 | 12-1/4 | 4 | 66 | 16d | 16 | 16d | 9845 | 9845 | 9845 | 6810 | 8270 | 8270 | 8270 | 5835 | 6, R13 |

- 1) Uplift loads have been increased 60% for wind or seismic loads; no further increase shall be permitted.
- 2) Joist nails need to be toe nailed at a 30° to 45° angle to achieve allowable loads shown.
- 3) Minimum nail penetration shall be 1-5/8" for 16d nails.

Some model designs may vary from illustration shown

Specialty Options Chart – refer to Specialty Options pages 194 to 195 for additional details.

| Option | Skewed ^{1,3} | Sloped Seat ^{2,3} | Sloped / Skewed ^{1,2,3} |
|-----------------|--|---|---|
| Range | 1° to 45° | 1° to 45° | See Sloped Seat and Skewed |
| Allowable Loads | 85% of table allowable load. 50% of table uplift load. | 85% of table allowable load | 52% of table allowable load. 50% of table uplift load. |
| Ordering | Add SK, angle required, and right (R) or left (L), to product number. Ex. THDH410-SK45R | Add SL, slope required, and up (U) or down (D), to product number. Ex. THDH410-SL30D | See Sloped Seat and Skewed. Ex. THDH410-SK45RSL30D |

- 1) Skewed THDH hangers with skews greater than 15° always have all joist nailing on one side of the outside flange.
 - 2) Sloped or sloped / skewed hangers with slopes greater than 15° may have additional joist nails.
 - 3) All sloped, skewed, or combinations require bevel cut on joist in all applications.
- Inverted flange option is not available for THDH models.

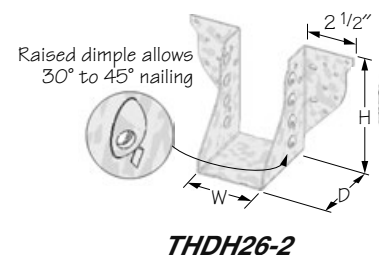

THDH26-2